



Madison, Wisconsin

CITY OF MADISON

CITY ENGINEERING DIVISION

DEPARTMENT OF PUBLIC WORKS

PLAN OF PROPOSED IMPROVEMENT

PUBLIC IMPROVEMENT PROJECT APPROVED

DATE: SEPTEMBER 5, 2023;
JULY 1, 2025; &
NOVEMBER 25, 2025

BY THE COMMON COUNCIL OF MADISON, WISCONSIN

PUBLIC IMPROVEMENT DESIGN APPROVED BY:

12/04/2025

City Engineer

Date

INDEX OF SHEETS

SHEET NO.	D1-D3	TYPICAL SECTIONS & DETAILS
SHEET NO.	EC1-EC3	EROSION CONTROL PLANS
SHEET NO.	P1-P3	STREET PLAN & PROFILES
SHEET NO.	U1-U8	SEWER PLAN & PROFILES & SCHEDULES
SHEET NO.	W1-W4	WATER PLAN & PROFILES & SCHEDULES
SHEET NO.	E1-E2	ELECTRICAL PLANS
SHEET NO.	PM1-PM5	PAVEMENT MARKING PLANS
SHEET NO.	X1-X3	CROSS SECTIONS

CITY MAINTENANCE PLAN NOT REQUIRED

ADDENDUM 1: 12/15/2025
REVISED SHEETS:
 D1, P3, PM2, PM3
ADDED SHEETS:
 PM4, PM5, X3

**HAWTHORNE COURT RECONSTRUCTION
 ASSESSMENT DISTRICT - 2023
 LAKE STREET SANITARY SEWER
 REPLACEMENT ASSESSMENT DISTRICT - 2025
 WEST DAYTON STREET SANITARY
 REPLACEMENT ASSESSMENT DISTRICT - 2025**
 CITY PROJECT NO. 14636 & 15938
 CONTRACT NO. 8733

CONVENTIONAL SIGNS	
FIELD VERIFY ALL UTILITY LOCATIONS	
GAS	— G —
STORM SEWER	— ST —
SANITARY SEWER	— SN —
WATER	— W —
BURIED ELECTRIC	— E —
OVERHEAD ELECTRIC	— OH —
POWER POLE	□
ADA COMPLIANT RAMP W/ DETECTABLE WARNING FIELD	■
COMBUSTIBLE FLUIDS	★

NOTES:

- ALL GUTTERS SHALL DRAIN WITH A MINIMUM GRADE OF 0.50% TOWARD STORM SEWER INLETS.
- SIDEWALK RAMPS SHALL HAVE A MAXIMUM SLOPE OF 1" PER 12".
- SIDEWALK AND CURB RAMPS SHALL BE CONSTRUCTED WITH A SIDE SLOPE OF 2.00%. SIDEWALK SHALL HAVE A MINIMUM LONGITUDINAL SLOPE OF 0.50% AND A MAXIMUM LONGITUDINAL SLOPE OF 5.00% EXCEPT WHERE STREET GRADES EXCEED 5.00%.
- SEE RELATED PRIVATE DEVELOPMENT PROJECT: 415 N LAKE ST - STATE STREET CAMPUS GARAGE MIXED USE. CITY PROJECT NO. 14892, CONTRACT NO. 9360



EARTH WORK SUMMARY:

EXCAVATION CUT (MEASURED PLAN QUANTITY) = 800 C.Y.
 ESTIMATED UNDISTRIBUTED UNDERCUT = 300 C.Y.
 TOTAL UNCLASSIFIED EXCAVATION CUT = 1,100 C.Y.

PAVEMENT MARKINGS DESIGNED BY:

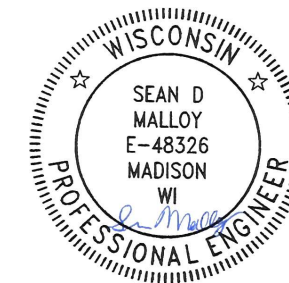

12/04/2025

STREET DESIGNED BY:

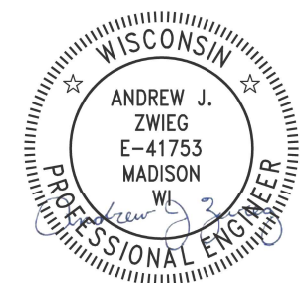

12/04/2025

ELECTRICAL DESIGNED BY:

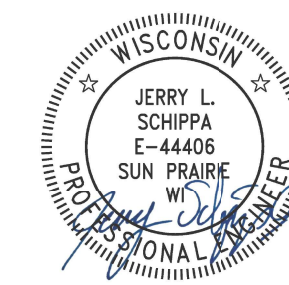

12/04/2025

SANITARY SEWER DESIGNED BY:



12/04/2025

WATER DESIGNED BY:



12/05/2025

STORM SEWER DESIGNED BY:

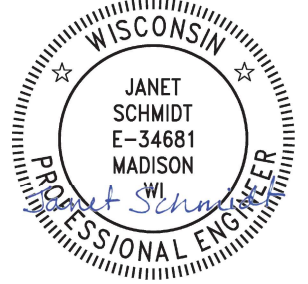

12/04/2025

PLOT SCALE: 1 IN. = 1 FT. XREF

PLOT NAME: ---

REV. DATE: 12/4/2025 11:24 AM

ORIGINATOR: CITY_OF_MADISON

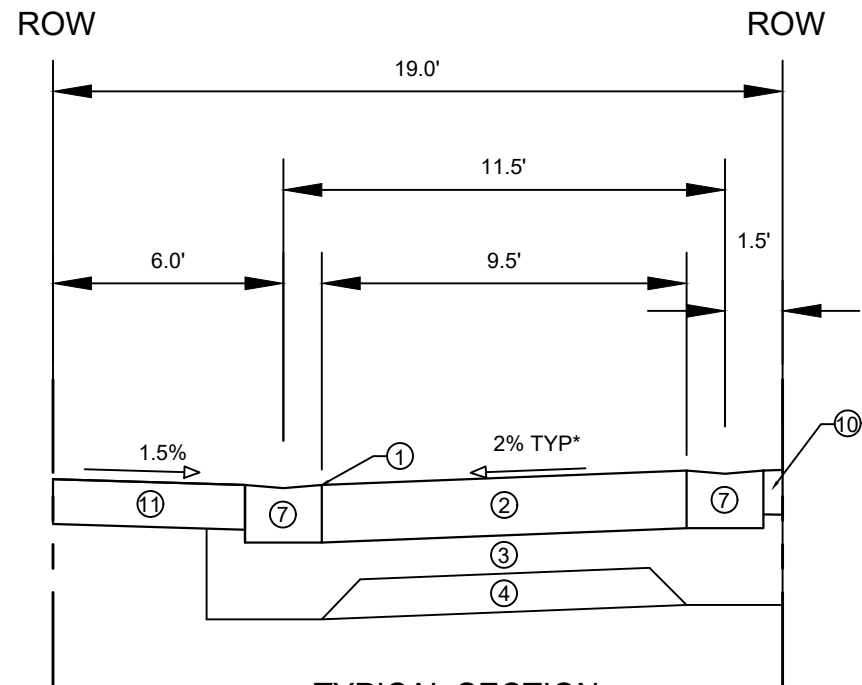

TYPICAL SECTION
HAWTHORNE COURT
STA 100+34.52 - STA 100+67.75

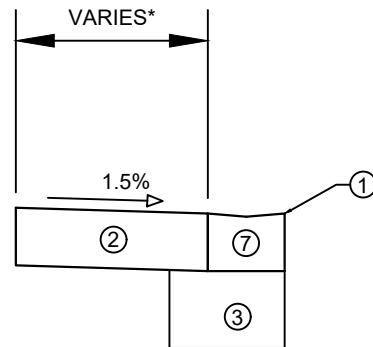

TYPICAL SECTION
HAWTHORNE COURT BUS ENTRANCE
STA 103+58.11 - STA 104+17.01

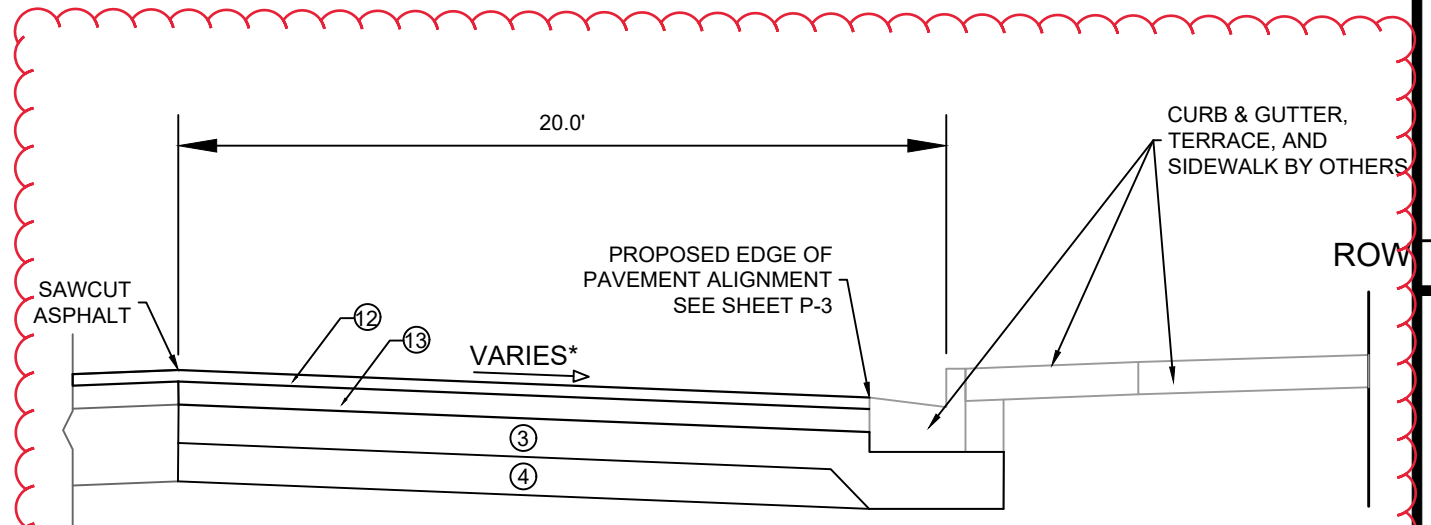

TYPICAL SECTION
N. LAKE ST
STA 101+55.85 - STA 104+22.55

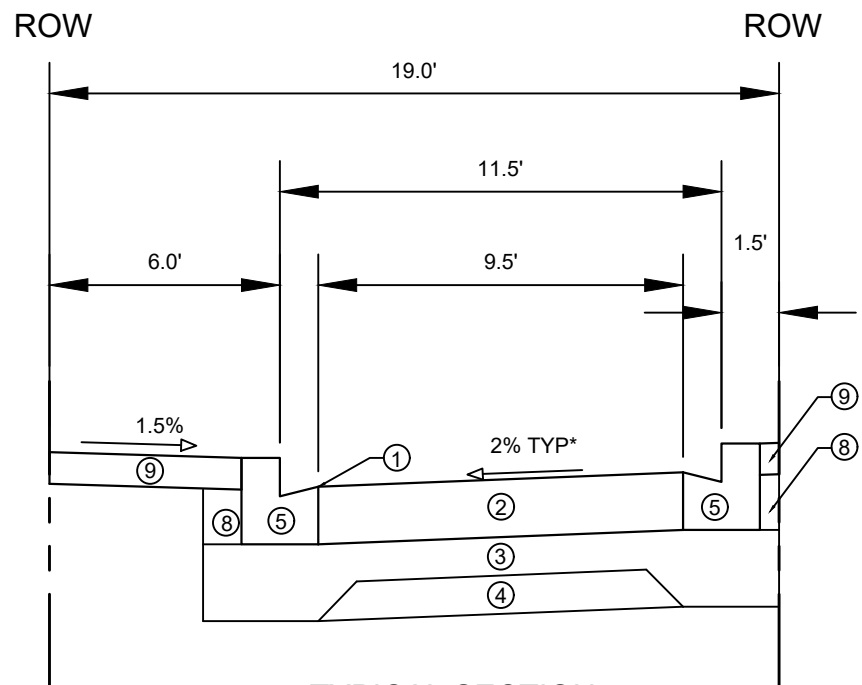

TYPICAL SECTION
HAWTHORNE COURT
STA 100+74.75 - STA 102+98.75

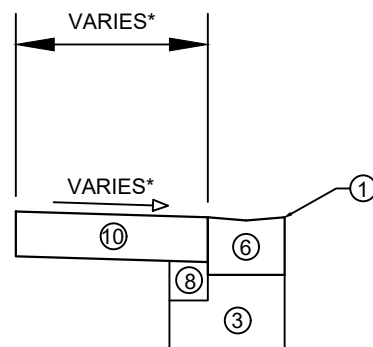

TYPICAL SECTION
HAWTHORNE COURT TURNAROUND

- ① POINT REFERRED TO ON PROFILE
- ② 9" CONCRETE PAVEMENT
- ③ 6" CRUSHED AGGREGATE BASE COURSE GRADATION 2 (UPPER LAYER)
- ④ 6" CRUSHED AGGREGATE BASE COURSE GRADATION 1 (LOWER LAYER)
- ⑤ MODIFIED TYPE 'H' CONCRETE CURB & GUTTER (DETAIL 1)
- ⑥ MODIFIED TYPE 'H' CONCRETE CURB & GUTTER CURB CUT (DETAIL 2)
- ⑦ MODIFIED TYPE 'H' CONCRETE CURB & GUTTER REINFORCED CURB CUT (DETAIL 3)
- ⑧ FILL INCIDENTAL TO CURB AND GUTTER INSTALLATION
- ⑨ 5" CONCRETE SIDEWALK
- ⑩ 7" CONCRETE SIDEWALK & DRIVE
- ⑪ COLORED 7" CONCRETE (NATURAL BARK)
- ⑫ 2" HMA PAVEMENT 4 MT 58-28 S (UPPER LAYER)
- ⑬ 3.5" HMA PAVEMENT 3 MT 58-28 S (LOWER LAYER)

NOTES:
 - TYPICAL SECTIONS NOT TO SCALE
 - SEE PRIVATE DEVELOPMENT PLANS FOR N. LAKE ST LOCATED AT:
[HTTPS://WWW.CITYOFMADISON.COM/BUSINESS/PW/UTILITYPLANS/](https://www.cityofmadison.com/business/pw/utilityplans/)
 (PROJECT 14892 - LAKE ST., N., 415., STATE STREET CAMPUS GARAGE MIXED USE)
 *SEE X-SHEETS FOR CROSS SLOPES AND WIDTHS

ADD 1	REVISION	DATE	BY
ADD 1	ADDENDUM 1	12/15/25	RES
		12/17/2025	BT
		3:19 PM	
	Designed By:	14636	
	Scale:		D-1

14636
 HAWTHORNE COURT RECONSTRUCTION ASSESSMENT DISTRICT - 2023
 MADISON, WI
 CONTRACT NO: 8733
 M:\DESIGN\Projects\14636\CAD\Streets\14636EN-Details.dwg



14636
 D-1

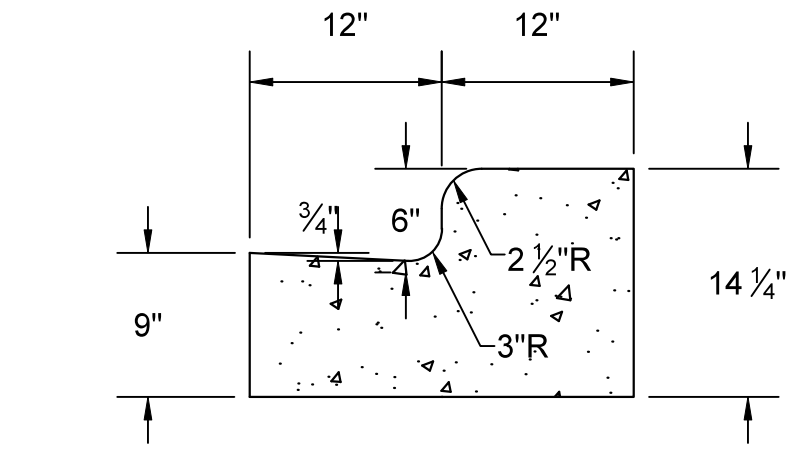

DETAIL 1 - MODIFIED TYPE 'H' CONCRETE CURB & GUTTER

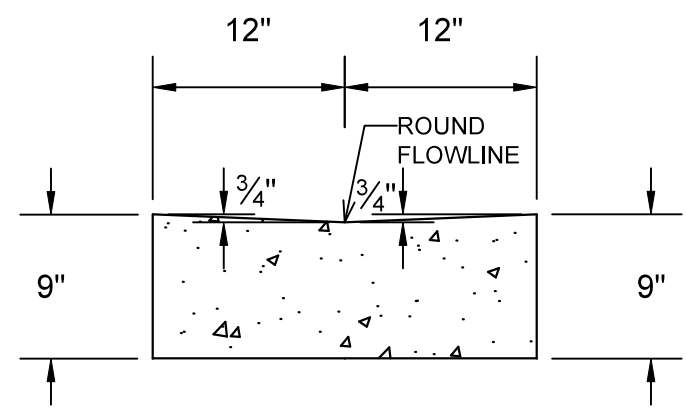

DETAIL 2 - MODIFIED TYPE 'H' CONCRETE CURB & GUTTER CURB CUT

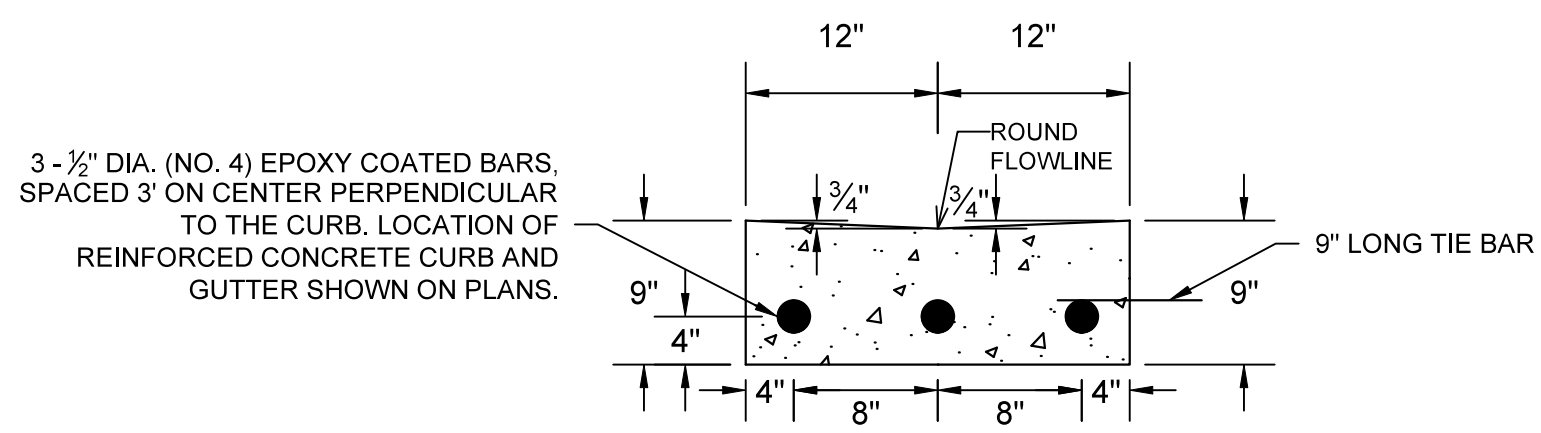

3 - 1/2" DIA. (NO. 4) EPOXY COATED BARS, SPACED 3' ON CENTER PERPENDICULAR TO THE CURB. LOCATION OF REINFORCED CONCRETE CURB AND GUTTER SHOWN ON PLANS.

9" LONG TIE BAR

DETAIL 3 - MODIFIED TYPE 'H' CONCRETE CURB & GUTTER REINFORCED CURB CUT

NOTES:
 SEE P-SHEETS FOR LOCATIONS OF REINFORCED CURB & GUTTER
 * SEAL ALL EXPOSED SURFACES OF 1/2" JOINT FILLER (1/2" MIN. DEEP AND HOLD 1/8" BELOW SURFACE OF CONCRETE). COLOR OF JOINT SEALER TO BE VERIFIED BY ENGINEER.

MARK	REVISION	DATE	BY
14636		10/30/2025	2:59 PM
Designed By:	Scale:		
			D-2

CONSTRUCTION DETAILS
 14636
 HAWTHORNE COURT RECONSTRUCTION ASSESSMENT DISTRICT - 2023
 MADISON, WI
 CONTRACT NO: 8733
 M:\DESIGN\Projects\14636\CAD\Streets\14636EN-Details.dwg



14636
 D-2



- Notes:
- COLOR
BACKGROUND = ORANGE
MESSAGE = BLACK
BORDER = BLACK
 - LETTERING SERIES = C
 - MINIMUM SIGN REFLECTIVITY = HIGH INTENSITY PRISMATIC GRADE
 - SIGN MATERIAL MAY BE PLASTIC OR METAL
 - CONTRACTOR SHALL MAINTAIN SIGNS FOR DURATION OF PROJECT ATTACHED TO TYPE III BARRICADE



14636

D-3

PROJECT SIGN DETAIL

HAWTHORNE COURT RECONSTRUCTION ASSESSMENT DISTRICT - 2023 MADISON, WI

M:\DESIGN\Projects\14636\CAD\Traffic\14636TE-PavementMarking.dwg

14636

8733

CONTRACT NO:

MARK	REVISION	DATE	BY
14636	10/30/2025 3:08 PM		

D-3

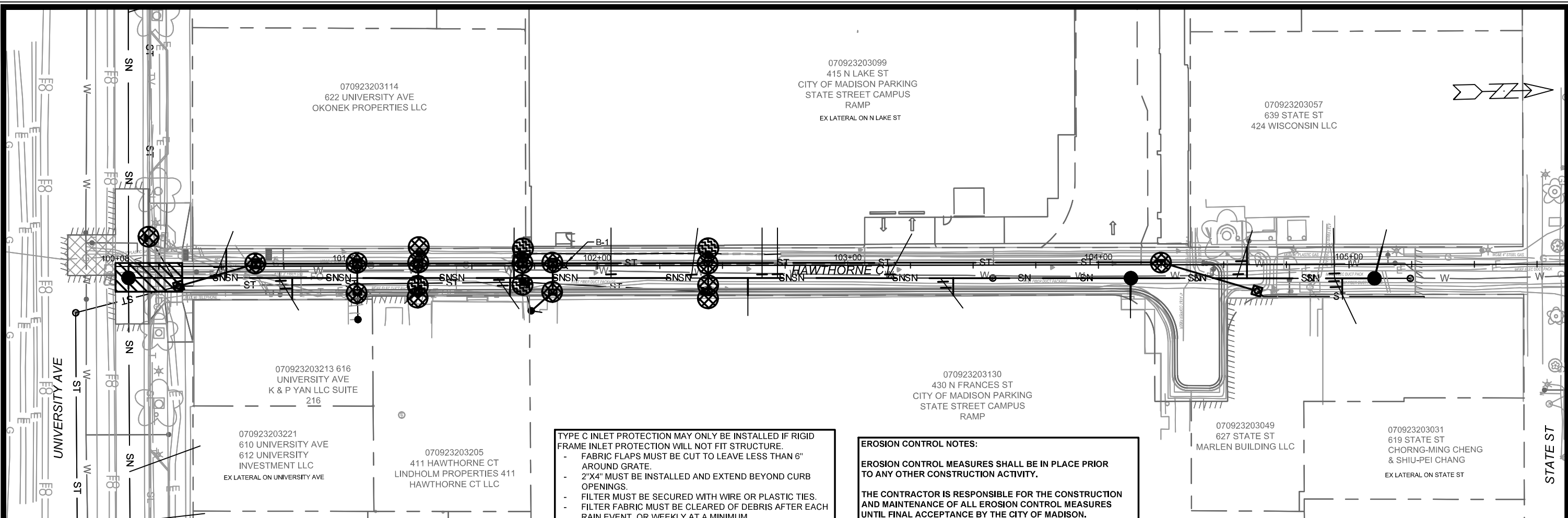

TYPE C INLET PROTECTION MAY ONLY BE INSTALLED IF RIGID FRAME INLET PROTECTION WILL NOT FIT STRUCTURE.

- FABRIC FLAPS MUST BE CUT TO LEAVE LESS THAN 6" AROUND GRATE.
- 2"x4" MUST BE INSTALLED AND EXTEND BEYOND CURB OPENINGS.
- FILTER MUST BE SECURED WITH WIRE OR PLASTIC TIES.
- FILTER FABRIC MUST BE CLEARED OF DEBRIS AFTER EACH RAIN EVENT, OR WEEKLY AT A MINIMUM.

EROSION CONTROL NOTES:

EROSION CONTROL MEASURES SHALL BE IN PLACE PRIOR TO ANY OTHER CONSTRUCTION ACTIVITY.

THE CONTRACTOR IS RESPONSIBLE FOR THE CONSTRUCTION AND MAINTENANCE OF ALL EROSION CONTROL MEASURES UNTIL FINAL ACCEPTANCE BY THE CITY OF MADISON.

THE CONTRACTOR SHALL INSTALL AND MAINTAIN EROSION CONTROL MEASURES IN ACCORDANCE WITH THE WDNRSOC STANDARDS AND CITY OF MADISON STANDARD SPECIFICATIONS.

THE CONTRACTOR SHALL PROVIDE STREET CLEANING AS NEEDED ON A DAILY BASIS TO KEEP TRACKING TO A MINIMUM.

INLET PROTECTION SHALL BE INSTALLED WITHIN THE CONSTRUCTION LIMITS. ADDITIONAL INLET PROTECTION SHALL BE PLACED AS DIRECTED.

POLYMER SHALL BE APPLIED TO DISTURBED AREAS AS DIRECTED BY THE CONSTRUCTION ENGINEER.

- RIGID FRAME INLET PROTECTION
- TYPE C INLET PROTECTION
- TRACKOUT CONTROL (CONSTRUCTION ENTRANCE)
- INSTALL TYPE HR FILTER FABRIC, 3" CLEAR STONE, MIN 1' DEPTH X 50' LONG X ROAD WIDTH
- SILT FENCE (PLACE AS NEEDED & AROUND STOCKPILES)

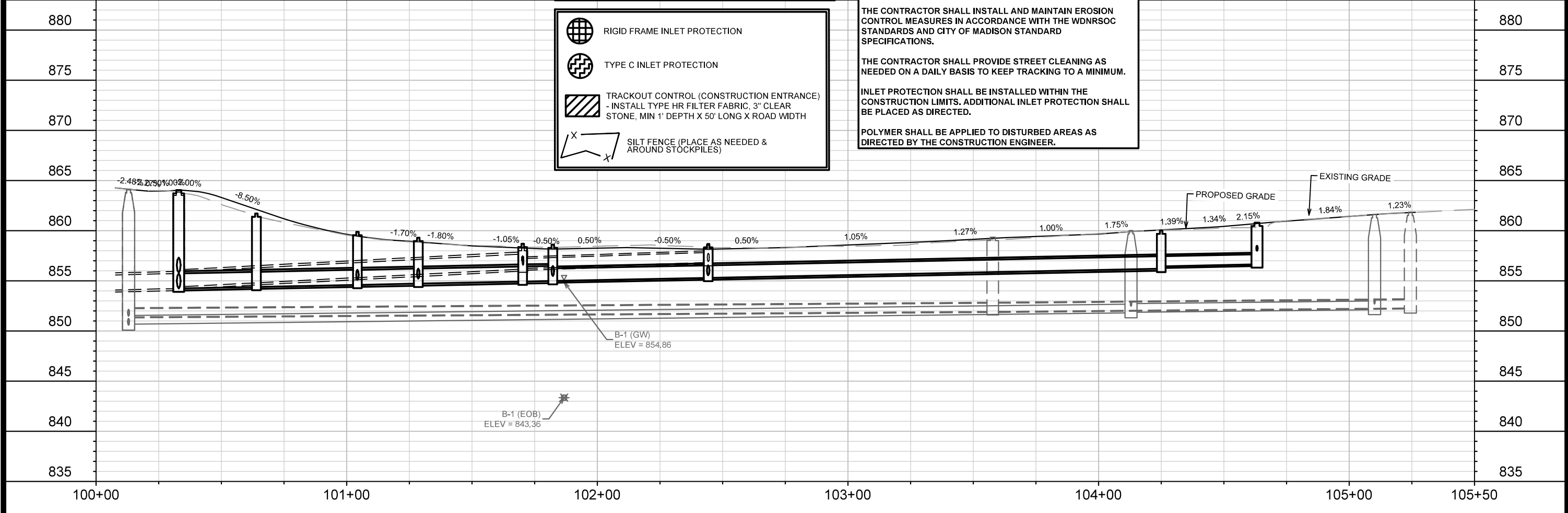

DATE	BY
REVISION	DATE
MARK	REVISION
Designed By: EEA	Date: 12/3/2025 10:27 AM
14636	Scale: 1" = 40'
14636	EC-1

14636
MADISON, WI
CONTRACT NO.: 8733

EROSION CONTROL PLAN - HAWTHORNE CT
HAWTHORNE COURT RECONSTRUCTION ASSESSMENT DISTRICT - 2023

M:\DESIGN\Projects\14636\CAD\Sewers\14636SWR-ErosionControl.dwg

CITY OF MADISON WISCONSIN

14636
EC-1

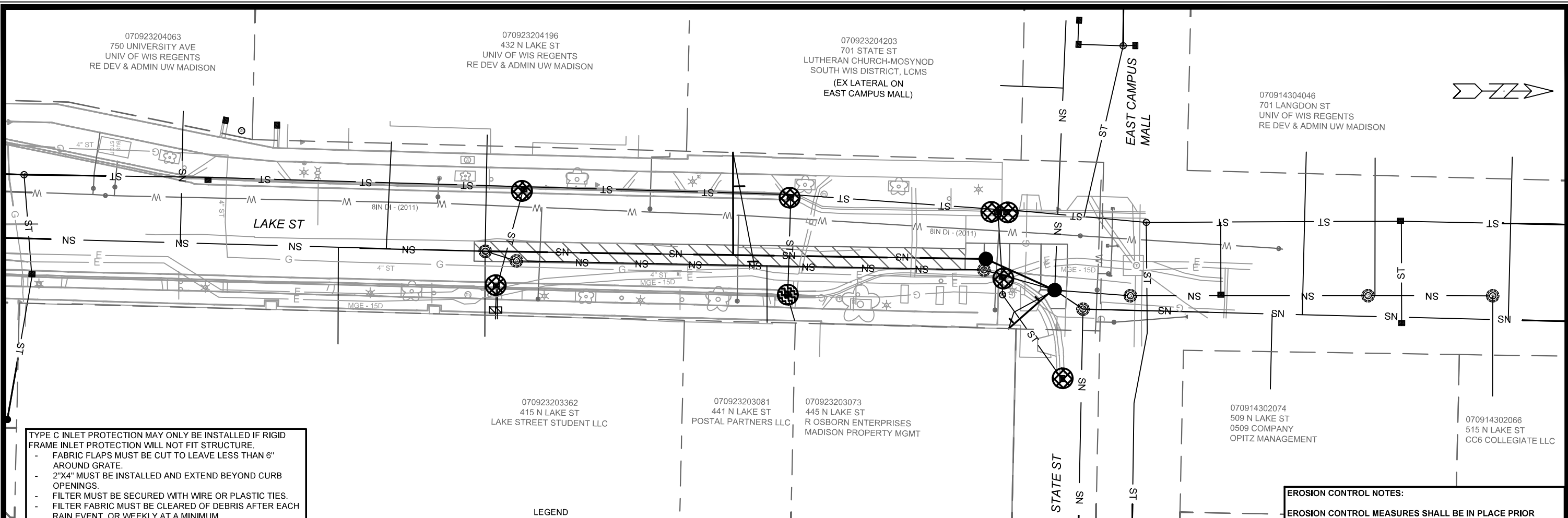

TYPE C INLET PROTECTION MAY ONLY BE INSTALLED IF RIGID FRAME INLET PROTECTION WILL NOT FIT STRUCTURE.

- FABRIC FLAPS MUST BE CUT TO LEAVE LESS THAN 6" AROUND GRATE.
- 2"X4" MUST BE INSTALLED AND EXTEND BEYOND CURB OPENINGS.
- FILTER MUST BE SECURED WITH WIRE OR PLASTIC TIES.
- FILTER FABRIC MUST BE CLEARED OF DEBRIS AFTER EACH RAIN EVENT, OR WEEKLY AT A MINIMUM.

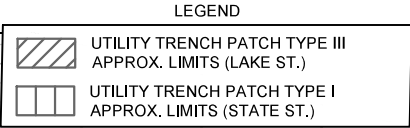
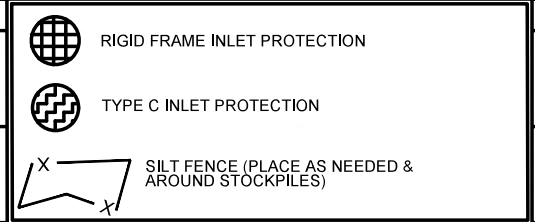

EROSION CONTROL NOTES:

EROSION CONTROL MEASURES SHALL BE IN PLACE PRIOR TO ANY OTHER CONSTRUCTION ACTIVITY.

THE CONTRACTOR IS RESPONSIBLE FOR THE CONSTRUCTION AND MAINTENANCE OF ALL EROSION CONTROL MEASURES UNTIL FINAL ACCEPTANCE BY THE CITY OF MADISON.

THE CONTRACTOR SHALL INSTALL AND MAINTAIN EROSION CONTROL MEASURES IN ACCORDANCE WITH THE WDNR SOC STANDARDS AND CITY OF MADISON STANDARD SPECIFICATIONS.

THE CONTRACTOR SHALL PROVIDE STREET CLEANING AS NEEDED ON A DAILY BASIS TO KEEP TRACKING TO A MINIMUM.

INLET PROTECTION SHALL BE INSTALLED WITHIN THE CONSTRUCTION LIMITS. ADDITIONAL INLET PROTECTION SHALL BE PLACED AS DIRECTED.

POLYMER SHALL BE APPLIED TO DISTURBED AREAS AS DIRECTED BY THE CONSTRUCTION ENGINEER.

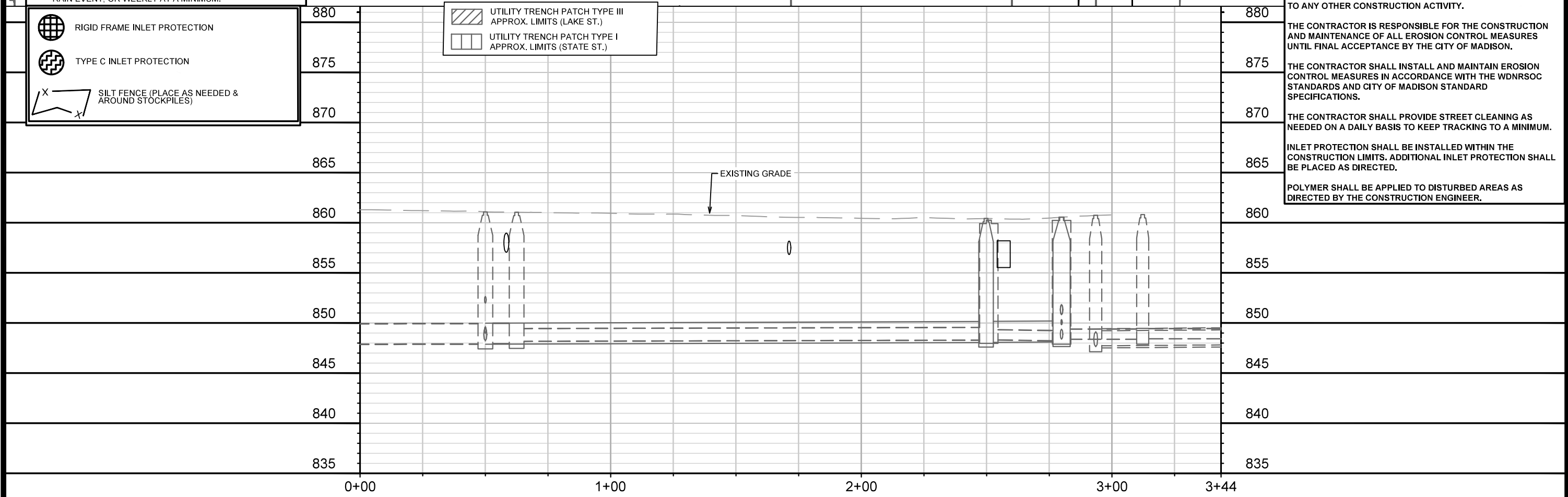

MARK	REVISION	DATE	BY
15938		11/12/2025	4:44 PM
DESIGNED BY: ##	15938	SCALE: 1" = 40'	EC-2

15938
MADISON, WI
CONTRACT NO: 8733
EROSION CONTROL PLAN - N. LAKE ST
LAKE STREET SANITARY SEWER REPLACEMENT ASSESSMENT DISTRICT - 2025
M:\DESIGN\Projects\14636\CAD\Sewers\15938\WR-ErosionControl.dwg

15938
EC-2

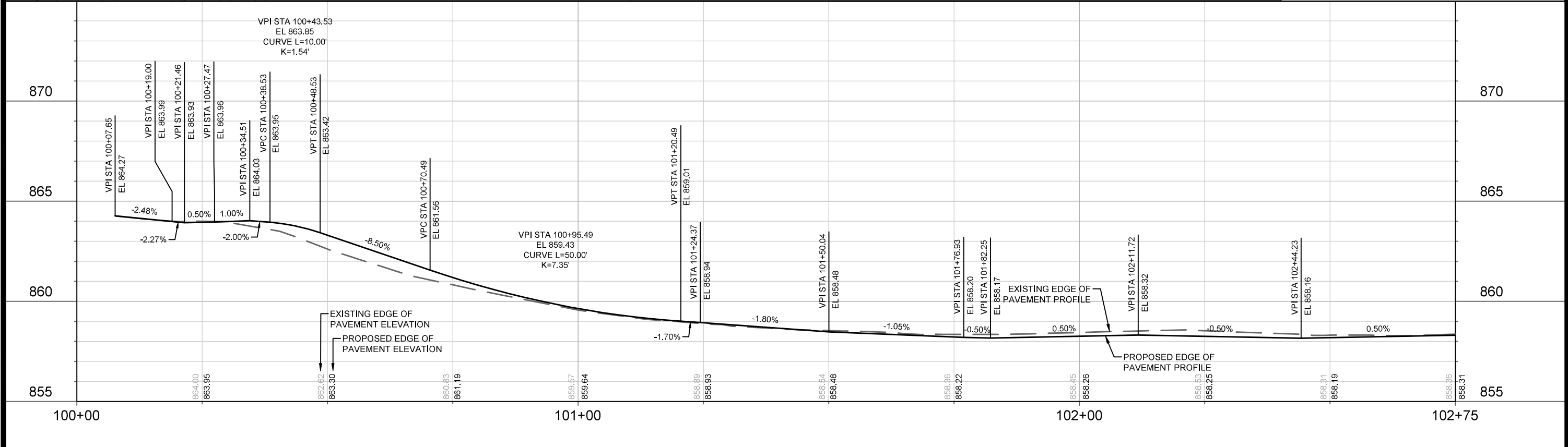
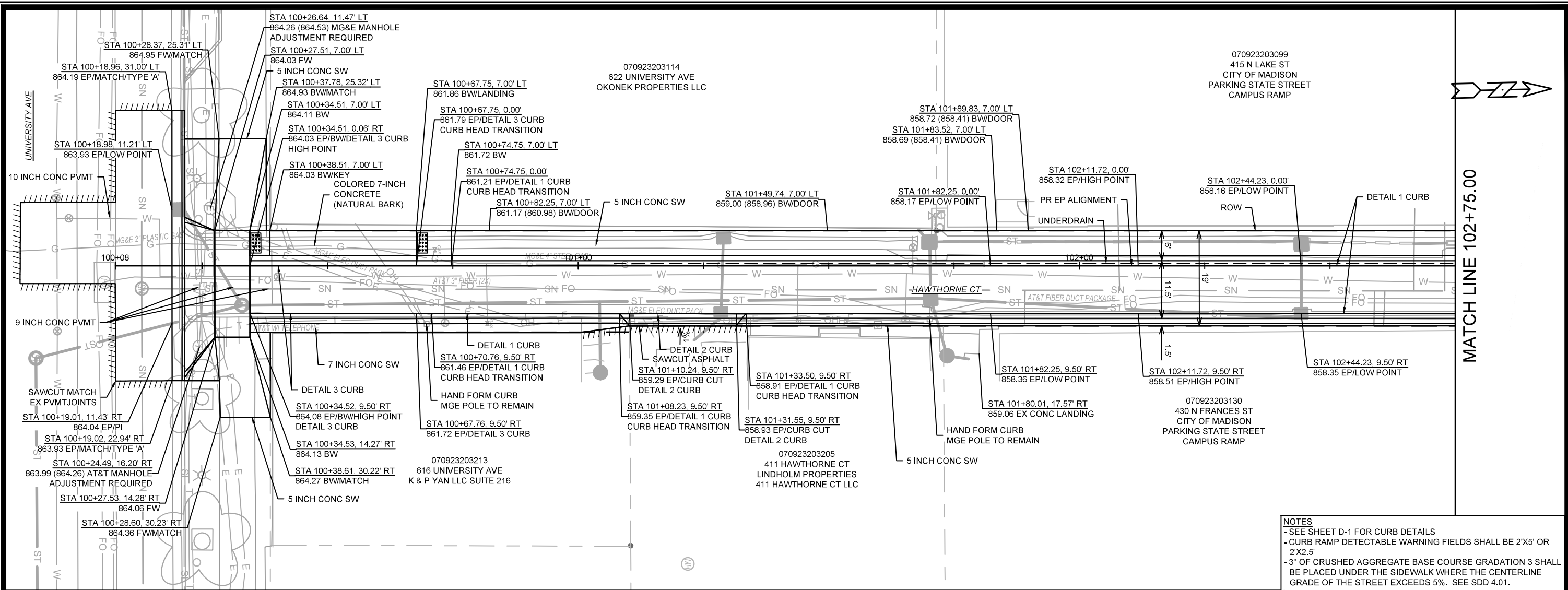

DATE	BY
REVISION	BY
MARK	BY
DESIGNED BY	DATE
12/3/2025 9:18 AM	Scale: 1" = 20'
14636	P-1

14636

MADISON, WI

CONTRACT NO: 8733

STREET PLAN & PROFILE - HAWTHORNE CT

HAWTHORNE COURT RECONSTRUCTION ASSESSMENT DISTRICT - 2023

M:\DESIGN\Projects\14636\CAD\Streets\14636EN-PrP_Hawthorne Ct.dwg

14636

P-1

MATCH LINE 102+75.00

070923203099
415 N LAKE ST
CITY OF MADISON
PARKING STATE STREET
CAMPUS RAMP

070923203057
639 STATE ST
424 WISCONSIN LLC

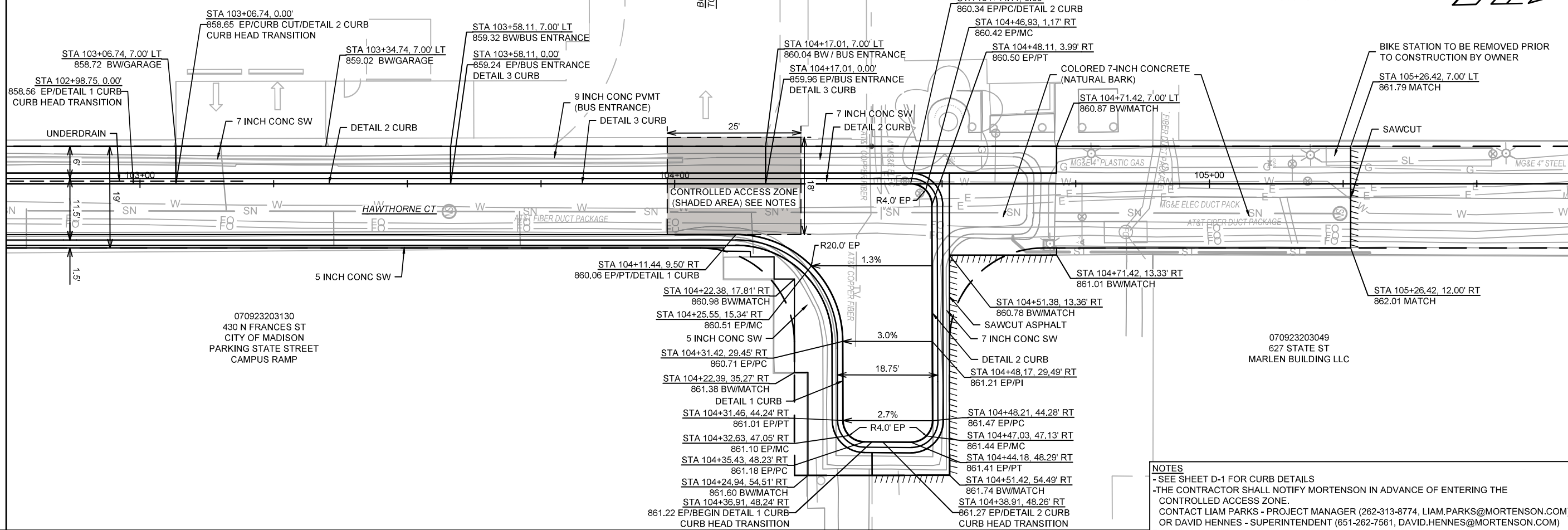

070923203130
430 N FRANCES ST
CITY OF MADISON
PARKING STATE STREET
CAMPUS RAMP

070923203049
627 STATE ST
MARLEN BUILDING LLC

- STA 104+11.44, 9.50' RT
860.06 EP/PT/DETAIL 1 CURB
- STA 104+22.38, 17.81' RT
860.98 BW/MATCH
- STA 104+25.55, 15.34' RT
860.51 EP/MC
- 5 INCH CONC SW
- STA 104+31.42, 29.45' RT
860.71 EP/PC
- STA 104+22.39, 35.27' RT
861.38 BW/MATCH
- DETAIL 1 CURB
- STA 104+31.46, 44.24' RT
861.01 EP/PT
- STA 104+32.63, 47.05' RT
861.10 EP/MC
- STA 104+35.43, 48.23' RT
861.18 EP/PC
- STA 104+24.94, 54.51' RT
861.60 BW/MATCH
- STA 104+36.91, 48.24' RT
861.22 EP/BEGIN DETAIL 1 CURB
- CURB HEAD TRANSITION
- STA 104+44.11, 0.00'
860.34 EP/PC/DETAIL 2 CURB
- STA 104+46.93, 1.17' RT
860.42 EP/MC
- STA 104+48.11, 3.99' RT
860.50 EP/PT
- COLORED 7-INCH CONCRETE
(NATURAL BARK)
- STA 104+71.42, 7.00' LT
860.87 BW/MATCH
- STA 104+11.44, 9.50' RT
860.06 EP/PT/DETAIL 1 CURB
- STA 104+22.38, 17.81' RT
860.98 BW/MATCH
- STA 104+25.55, 15.34' RT
860.51 EP/MC
- 5 INCH CONC SW
- STA 104+31.42, 29.45' RT
860.71 EP/PC
- STA 104+22.39, 35.27' RT
861.38 BW/MATCH
- DETAIL 1 CURB
- STA 104+31.46, 44.24' RT
861.01 EP/PT
- STA 104+32.63, 47.05' RT
861.10 EP/MC
- STA 104+35.43, 48.23' RT
861.18 EP/PC
- STA 104+24.94, 54.51' RT
861.60 BW/MATCH
- STA 104+36.91, 48.24' RT
861.22 EP/BEGIN DETAIL 1 CURB
- CURB HEAD TRANSITION
- STA 104+44.11, 0.00'
860.34 EP/PC/DETAIL 2 CURB
- STA 104+46.93, 1.17' RT
860.42 EP/MC
- STA 104+48.11, 3.99' RT
860.50 EP/PT
- COLORED 7-INCH CONCRETE
(NATURAL BARK)
- STA 104+71.42, 7.00' LT
860.87 BW/MATCH
- STA 104+51.38, 13.36' RT
860.78 BW/MATCH
- SAWCUT ASPHALT
- 7 INCH CONC SW
- DETAIL 2 CURB
- STA 104+48.17, 29.49' RT
861.21 EP/PI
- STA 104+48.21, 44.28' RT
861.47 EP/PC
- STA 104+47.03, 47.13' RT
861.44 EP/MC
- STA 104+44.18, 48.29' RT
861.41 EP/PT
- STA 104+51.42, 54.49' RT
861.74 BW/MATCH
- STA 104+38.91, 48.26' RT
861.27 EP/DETAIL 2 CURB
- CURB HEAD TRANSITION

NOTES
 - SEE SHEET D-1 FOR CURB DETAILS
 - THE CONTRACTOR SHALL NOTIFY MORTENSON IN ADVANCE OF ENTERING THE CONTROLLED ACCESS ZONE.
 CONTACT LIAM PARKS - PROJECT MANAGER (262-313-8774, LIAM.PARKS@MORTENSON.COM) OR DAVID HENNES - SUPERINTENDENT (651-262-7561, DAVID.HENNES@MORTENSON.COM)

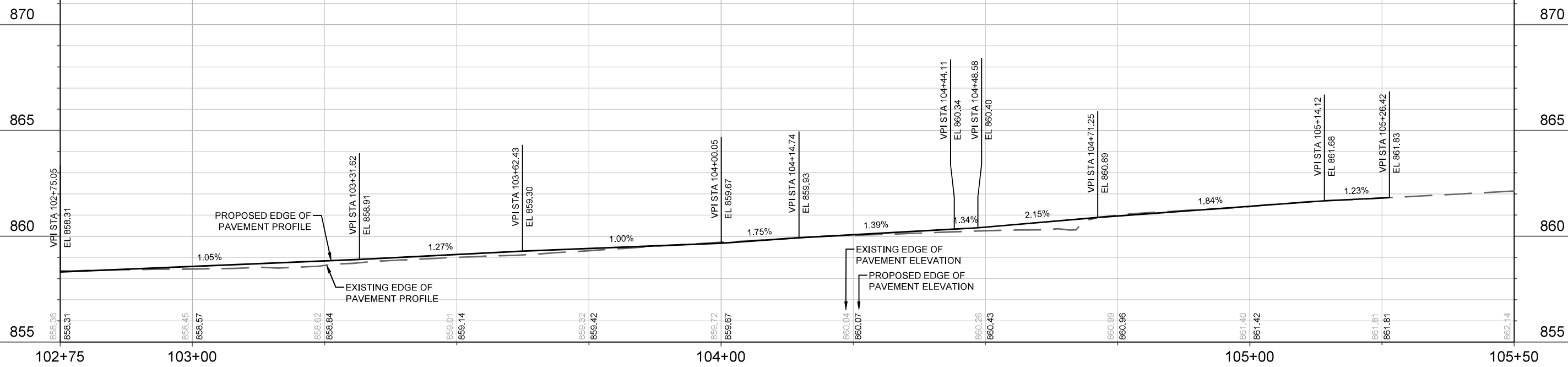

DATE	BY
REVISION	SCALE
MARK	DATE
14636	11/18/2023 3:56 PM
P-2	

14636
 MADISON, WI
 HAWTHORNE COURT RECONSTRUCTION ASSESSMENT DISTRICT - 2023
 CONTRACT NO: 8733

STREET PLAN & PROFILE - HAWTHORNE CT
 M:\DESIGN\Projects\14636\CAD\Streets\14636EN-PrP_Hawthorne Ct.dwg

14636
 P-2

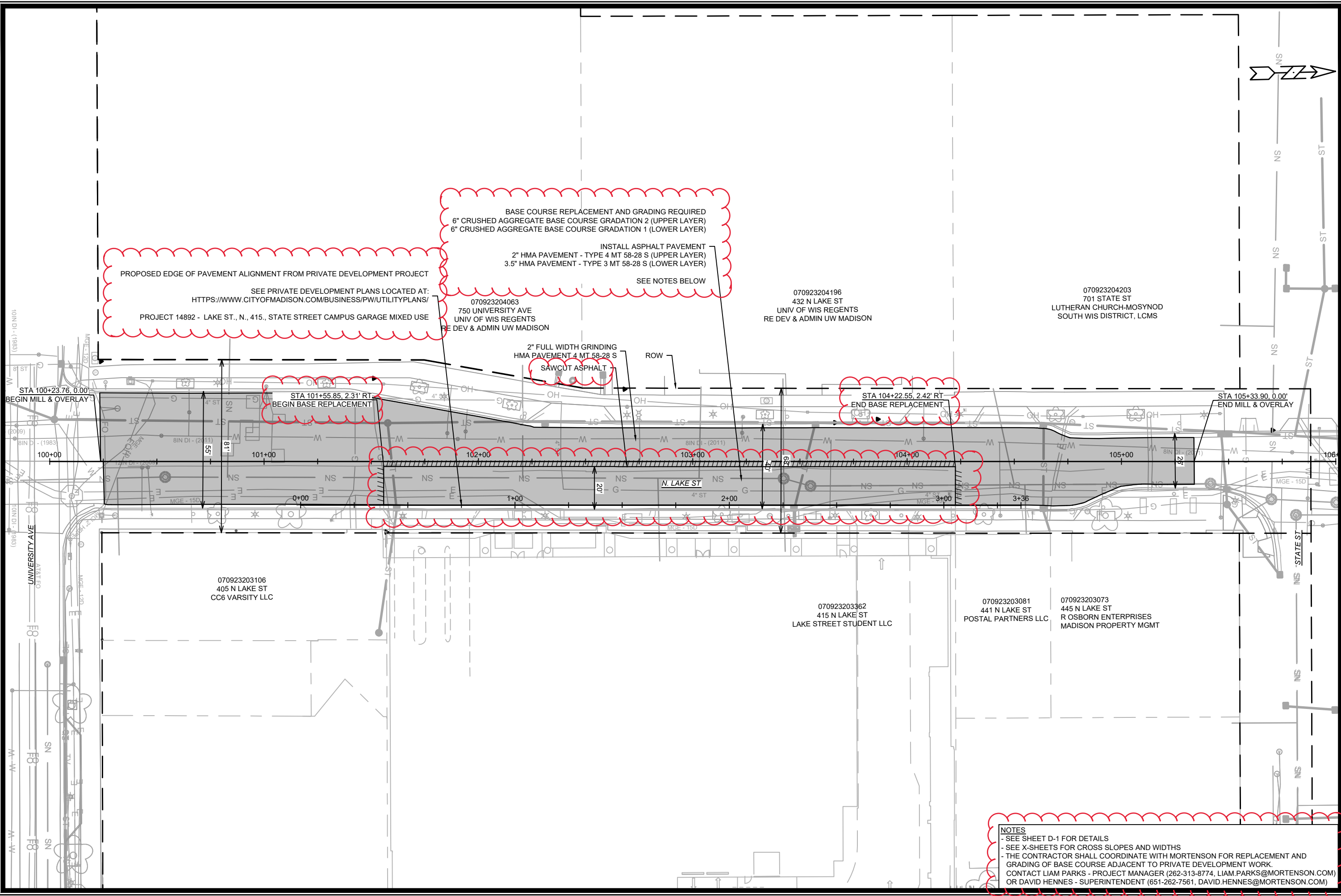

PROPOSED EDGE OF PAVEMENT ALIGNMENT FROM PRIVATE DEVELOPMENT PROJECT
 SEE PRIVATE DEVELOPMENT PLANS LOCATED AT:
[HTTPS://WWW.CITYOFMADISON.COM/BUSINESS/PW/UTILITYPLANS/](https://www.cityofmadison.com/business/pw/utilityplans/)
 PROJECT 14892 - LAKE ST., N., 415., STATE STREET CAMPUS GARAGE MIXED USE

BASE COURSE REPLACEMENT AND GRADING REQUIRED
 6" CRUSHED AGGREGATE BASE COURSE GRADATION 2 (UPPER LAYER)
 6" CRUSHED AGGREGATE BASE COURSE GRADATION 1 (LOWER LAYER)
 INSTALL ASPHALT PAVEMENT
 2" HMA PAVEMENT - TYPE 4 MT 58-28 S (UPPER LAYER)
 3.5" HMA PAVEMENT - TYPE 3 MT 58-28 S (LOWER LAYER)
 SEE NOTES BELOW

070923204063
 750 UNIVERSITY AVE
 UNIV OF WIS REGENTS
 RE DEV & ADMIN UW MADISON

070923204196
 432 N LAKE ST
 UNIV OF WIS REGENTS
 RE DEV & ADMIN UW MADISON

070923204203
 701 STATE ST
 LUTHERAN CHURCH-MOSYNOD
 SOUTH WIS DISTRICT, LCMS

2" FULL WIDTH GRINDING
 HMA PAVEMENT 4 MT 58-28 S
 SAWCUT ASPHALT

STA 100+23.76, 0.00'
 BEGIN MILL & OVERLAY

STA 101+55.85, 2.31' RT
 BEGIN BASE REPLACEMENT

STA 104+22.55, 2.42' RT
 END BASE REPLACEMENT

STA 105+33.90, 0.00'
 END MILL & OVERLAY

070923203106
 405 N LAKE ST
 CC6 VARSITY LLC

070923203362
 415 N LAKE ST
 LAKE STREET STUDENT LLC

070923203081
 441 N LAKE ST
 POSTAL PARTNERS LLC

070923203073
 445 N LAKE ST
 R OSBORN ENTERPRISES
 MADISON PROPERTY MGMT

NOTES
 - SEE SHEET D-1 FOR DETAILS
 - SEE X-SHEETS FOR CROSS SLOPES AND WIDTHS
 - THE CONTRACTOR SHALL COORDINATE WITH MORTENSON FOR REPLACEMENT AND GRADING OF BASE COURSE ADJACENT TO PRIVATE DEVELOPMENT WORK.
 CONTACT LIAM PARKS - PROJECT MANAGER (262-313-8774, LIAM.PARKS@MORTENSON.COM)
 OR DAVID HENNES - SUPERINTENDENT (651-262-7561, DAVID.HENNES@MORTENSON.COM)

ADD. 1	ADDENDUM 1	DATE	12/15/25	RES	BY
MARK	REVISION	DATE	12/15/25	RES	BY
Designed By: ##	15938	Date:	12/12/2025 11:44 AM	Scale:	1" = 40'

15938
 MADISON, WI
 CONTRACT NO.: 8733
 STREET PLAN - N. LAKE ST
 LAKE STREET SANITARY SEWER REPLACEMENT ASSESSMENT DISTRICT - 2025
 M:\DESIGN\Projects\14636\CAD\Streets\14636EN-PrP_N LAKE ST.dwg

15938
 P-3

SANITARY SEWER SCHEDULE

HAWTHORNE COURT RECONSTRUCTION ASSESSMENT DISTRICT - 2023 PROJECT NO. 14636	SHEET NO. U-2
SANITARY SEWER SCHEDULE	
CITY OF MADISON	

U-2

PROPOSED SANITARY STRUCTURES

SAS NO.	STATION	LOCATION (OFFSET)	TOP OF CASTING	E.I.	DEPTH (FT)	NOTES
HAWTHORNE COURT						
SAS #1	100+12.94	RT-4.58	864.13	850.70	13.43	[1]; [2]; [3]; [4]
SAS #2	104+12.94	RT-5.32	860.01	851.82	8.19	[1]; [2]
SAS #3	105+10.10	RT-5.54	861.62	852.14	9.48	[1]; [2]; [5]

SANITARY STRUCTURE REMOVALS & ABANDONMENTS

STRUC ID NO.	STATION	LOCATION (OFFSET)	TOP OF CASTING	E.I.	DEPTH	NOTES
HAWTHORNE COURT						
SAS4850-068	100+12.94	RT-4.58	864.09	850.58	13.51	4' DIA.
SAS4850-023	103+57.80	RT-5.19	859.35	851.94	7.41	4'X4' RECT.
SAS4850-050	105+24.40	RT-5.57	861.85	852.29	9.56	4' DIA.

SPECIFIC NOTES

- [1] INSTALL RIGID INTERNAL CHIMNEY SEAL IN CONFORMANCE WITH S.D.D. 5.7.17
- [2] INSTALL EXTERNAL SAS WRAP IN CONFORMANCE WITH S.D.D. 5.7.2
- [3] CONNECT TO EX 8" PVC MAIN (EI(E) = 850.58)
- [4] 8" TAP (EI(W) = 851.49) FOR UPSTREAM MAIN CONNECTION
- [5] 6" TAP (EI(W) = 852.68) FOR LATERAL CONNECTION
- [6] DUCTILE IRON WYES TO BE USED FOR LATERAL CONNECTIONS ON C-900 SANITARY SEWER MAIN

PROPOSED SANITARY PIPES

FROM (DNSTM)	TO (UPSTM)	DWNSTRM E.I.	UPSTRM E.I.	PLAN LGTH (FT)	SLOPE (%)	PVC TYPE	NOTES
HAWTHORNE COURT							
SAS #1	SAS #2	850.70	851.82	400	0.28%	10"	SDR-26
SAS #2	SAS #3	851.87	852.14	97	0.28%	10"	[6]; C-900

SANITARY PIPE REMOVALS & ABANDONMENTS

REMOVE FROM	REMOVE TO	LGTH (FT)	PAID (Y/N)	REM LGTH (FT)	REM LGTH PAID (FT)	ABN LGTH (FT)	SLURRY CY	PIPE SIZE	PIPE TYPE	NOTES
HAWTHORNE COURT										
SAS4850-068	SAS4850-023	345	N	345	-	-	-	10"	VCP	
SAS4850-023	SAS #3	152	N	152	-	-	-	10"	VCP	
SAS #3	SAS4850-050	14	Y	-	-	-	14 0.28	10"	VCP	

STORM SEWER SCHEDULE

HAWTHORNE COURT RECONSTRUCTION ASSESSMENT DISTRICT - 2023 PROJECT NO. 14636	SHEET NO. U-3	U-3
STORM SEWER SCHEDULE		
CITY OF MADISON		

PROPOSED STORM STRUCTURES

STRUC. NO.	STATION	LOCATION (OFFSET)	TYPE	TOP OF CASTING	E.I.	DEPTH	NOTES
HAWTHORNE COURT							
S-1	100+32.95	RT-7.92	3'X3' STORM SAS	864.05	854.24	9.81	[1]; [2]; W/R-1550-0054
S-2	100+63.95	LT-1.00	3'X3' STORM SAS	862.05	854.40	7.65	[3]; R-3362-L
S-3	101+04.26	LT-1.00	3'X3' STORM SAS	859.90	854.60	5.30	W/R-3067-7004-V
S-3A	101+04.26	RT-10.50	H-INLET	859.92	855.16	4.76	[4]; W/R-3067-7004-V
S-4	101+28.55	LT-1.00	3'X3' STORM SAS	859.31	854.72	4.59	W/R-3067-7004-V
S-4A	101+28.55	RT-10.50	H-INLET	858.91	855.28	3.63	[3]; [5]; R-3362-L
S-5	101+70.20	LT-1.00	3'X3' STORM SAS	858.71	854.93	3.78	[6]; FP; W/R-3067-7004-V
S-6	101+82.23	LT-1.00	3'X3' STORM SAS	858.61	854.99	3.62	LP; FP; W/R-3067-7004-VB
S-6A	101+82.23	RT-10.50	H-INLET	858.80	855.55	3.25	[7]; LP; W/R-3067-7004-VB
S-7	102+44.22	LT-1.00	H-INLET	858.60	855.30	3.30	LP; W/R-3067-7004-VB
S-7A	102+44.22	RT-10.50	H-INLET	858.79	855.61	3.18	LP; W/R-3067-7004-VB
S-8	104+25.00	LT-1.00	H-INLET	860.01	856.20	3.81	[3]; R-3362-L
S-9	104+63.21	RT-10.50	3'X3' STORM SAS	860.79	856.65	4.14	[8]; W/R-1550-0054

PROPOSED STORM PIPES

PIPE NO.	FROM (DNSTM)	TO (UPSTM)	DISCH. E.I.	INLET E.I.	PLAN (PAY) LGTH (FT)	PIPE LGTH (FT)	SLOPE (%)	PIPE SIZE	TYPE	NOTES
HAWTHORNE COURT										
P-1	S-1	S-2	854.24	854.40	32	29	0.55%	18"	RCP	
P-2	S-2	S-3	854.40	854.60	40	37	0.54%	18"	RCP	
P-3	S-3	S-4	854.60	854.72	24	21	0.57%	18"	RCP	
P-3A	S-3	S-3A	855.10	855.16	12	9	0.67%	12"	RCP	
P-4	S-4	S-5	854.72	854.93	42	39	0.54%	18"	RCP	
P-4A	S-4	S-4A	855.22	855.28	12	9	0.67%	12"	RCP	
P-5	S-5	S-6	854.93	854.99	12	9	0.67%	18"	RCP	
P-6	S-6	S-7	854.99	855.30	62	59	0.53%	15"	RCP	NCM
P-6A	S-6	S-6A	855.49	855.55	12	9	0.67%	12"	RCP	
P-7	S-7	S-8	855.30	856.20	181	178	0.51%	15"	RCP	
P-7A	S-7	S-7A	855.55	855.61	12	10	0.60%	12"	RCP	
P-8	S-8	S-9	856.45	856.65	40	37	0.54%	12"	RCP	

SPECIFIC NOTES:

- [1] CONNECT TO EX 18" RCP STM MAIN WITH CONCRETE COLLAR (S-1) AFTER RS-1 REMOVAL, APPROX EI(SE) = 854.24
- [2] CONNECT TO EX 18" RCP STM MAIN WITH CONCRETE COLLAR (S-1) AFTER RS-1 REMOVAL, APPROX EI(SW) = 855.82
- [3] TOP OF INLET CASTING SET TO MATCH FLOWLINE OF ALLEY CURB / CURB CUT. SEE SHEET D-2
- [4] CONNECT EX PVT 4" CI STM (TYPE 1 RECONNECT), APPROX EI(E) = 855.65
- [5] CONNECT EX PVT 6" PVC STM (TYPE 1 RECONNECT), APPROX EI(SE) = 856.50
- [6] CONNECT EX PVT 6" PVC STM (TYPE 2 RECONNECT), APPROX EI(SW) = 856.94 & CONNECT EX ROOF DRAIN (TYPE 2 RECONNECT), APPROX EI(W) = 856.94
- [7] CONNECT EX PVT STM (TYPE 2 RECONNECT), APPROX EI(W) = 856.73 - USE 8" PVC FOR NEW PIPING
- [8] CONNECT EX PVT STM CURB SCUPPER (TYPE 1 RECONNECT) - CONTRACTOR TO FIELD VERIFY MATERIAL & SIZE, INSTALL BENDS AS NEEDED TO CONNECT TO S-9

STANDARD NOTES:

- ABBREVIATIONS: AE = APRON ENDWALL; RCP = REINFORCED CONCRETE PIPE; HERCP = HORIZONTAL ELLIPTICAL REINFORCED CONCRETE PIPE; DNA = DOES NOT APPLY; SAS = SEWER ACCESS STRUCTURE; LP = LOW POINT INLET STRUCTURE; FP = FIELD POURED STRUCTURE; TR = TOP OF CONCRETE ROOF; NCM = NO CROWN MATCH FOR PIPES; UD = UNDERDRAIN
- PLAN LENGTH (PAY LENGTH) IS FROM CENTER OF STRUCTURE TO CENTER OF STRUCTURE. PIPE LENGTH IS ACTUAL LENGTH OF PIPE FROM STRUCTURE WALL TO STRUCTURE WALL. SLOPE CALCULATED USING PIPE LENGTH.
- TOP OF CASTING GRADE GIVEN IS THE TOP OF CURB FOR INLET STRUCTURES AND THE FLOWLINE OF THE CLOSED CASTING FOR SAS UNLESS NOTED OTHERWISE.
- APPROXIMATE DISCHARGE E.I. GIVEN, ADJUST E.I. AND PIPE SLOPE IN THE FIELD.
- ALL REINFORCED CONCRETE PIPES TO BE CLASS 3 UNLESS OTHERWISE NOTED.
- ALL FIELD POURED SAS STORM STRUCTURES SHALL BE CONSTRUCTED IN ACCORDANCE WITH STANDARD DETAIL DRAWING 5.7.3. ALL PRECAST SAS STORM STRUCTURES SHALL BE CONSTRUCTED IN ACCORDANCE WITH STANDARD DETAIL DRAWING 5.7.5.
- ALL STRUCTURES CALLED OUT AS FIELD POURED SHALL BE FIELD POURED. ALL OTHER STRUCTURES STORM AND SANITARY (NOT INDICATED AS FIELD POURED) SHALL BE SUBMITTED TO CITY ENGINEERING FOR APPROVAL ECEFALU@CITYOFMADISON.COM ((608) 243-5894).
- ALL REBAR FOR FIELD POURED STRUCTURES SHALL BE EPOXY COATED. ANY EXPOSED STEEL SHALL BE TOUCHED UP OR RECOATED PRIOR TO USE.
- SURVEYOR TO CONFIRM THAT ALL INLET STATION / OFFSETS LINE UP WITH PROPOSED CURB AND GUTTER.

STORM SEWER SCHEDULE

HAWTHORNE COURT RECONSTRUCTION
ASSESSMENT DISTRICT - 2023
PROJECT NO. 14636

SHEET NO.
U-4

STORM SEWER SCHEDULE

CITY OF MADISON

U-4

STORM STRUCTURE REMOVALS & ABANDONMENTS

STRUC. NO.	ID NO.	STATION	LOCATION (OFFSET)	TYPE	DEPTH (FT)	NOTES
HAWTHORNE COURT						
RS-1	IN4850-132	100+32.95	RT-7.92	4'X4' SAS	9.61	
RS-2	IN4850-059	101+28.50	RT-10.35	3'X3' SAS	3.23	
RS-3	IN4850-058	101+29.02	LT-6.51	H-INLET	3.08	
RS-4	IN4850-053	101+70.34	RT-6.52	3'X3' SAS	2.15	
RS-5	IN4850-054	101+70.13	LT-4.70	3'X3' SAS	1.39	
RS-6	IN4850-051	102+44.27	RT-10.52	H-INLET	1.90	
RS-7	IN4850-052	102+44.28	LT-4.27	3'X3' SAS	1.43	

STORM PIPE REMOVALS & ABANDONMENTS

PIPE REMOVAL NO.	REMOVE FROM	REMOVE TO	LGTH (FT)	PAID (Y/N)	REM PAID (FT)	ABN LGTH (FT)	SLURRY (CY)	PIPE SIZE	PIPE TYPE	NOTES
HAWTHORNE COURT										
RP-1	RS-1	RS-4	137	N	-	-	-	18"	RCP	
RP-2	RP-1 EX PVT STM CONNECTION #1	S-3A	4	N	-	-	-	4"	CI	
RP-3	RP-1 EX PVT STM CONNECTION #2	RS-3	13	N	-	-	-	12"	RCP	
RP-4	RS-4	RS-5	11	N	-	-	-	8"	RCP	
RP-5	RS-5	RS-7	74	N	-	-	-	8"	PVC SLOT DRAIN	
RP-6	RS-6	RS-7	15	N	-	-	-	10"	PVC	
RP-7	RS-7	SLOT DRAIN BREAK #1	5	N	-	-	-	8"	PVC SLOT DRAIN	
RP-8	SLOT DRAIN BREAK #2	SLOT DRAIN BREAK #3	7	N	-	-	-	8"	PVC SLOT DRAIN	
ABNP-1	RS-4	RS-6	74	Y	-	74	2.15	12"	RCP	

STORM STRUCTURE ADJUSTMENTS

STRUC. NO.	ID NO.	STATION	LOCATION (OFFSET)	EX TOC	PROP TOC	ADJ (FT)	NOTES
HAWTHORNE COURT							
ADJ-1	IN4850-133	100+21.42	LT-11.22	864.47	864.31	-0.16	

STORM ULO SCHEDULE

ID NO.	STATION	LOCATION (OFFSET)	TYPE	NOTES
HAWTHORNE COURT				
ULO1A-TV	100+23.97	RT-10.22	CATV	
ULO1B-SL	100+24.76	RT-10.02	CITY OF MADISON SIGNAL	
ULO1C-TV	100+24.90	RT-9.99	CATV	
ULO1D-E	100+26.04	RT-9.69	ELECTRIC DUCT PACKAGE	
ULO2-T	100+33.62	RT-11.86	AT&T WI TELEPHONE	
ULO3-FO	100+49.16	RT-3.26	AT&T FIBER OPTC (2X)	
ULO4-E	100+54.34	RT-1.77	MG&E ELECTRIC DUCT PACKAGE	
ULO5-FO	101+04.26	RT-4.82	AT&T FIBER OPTC (2X)	
ULO6A-T	101+04.26	RT-10.31	AT&T WI TELEPHONE	
ULO6B-E	101+05.32	RT-10.81	MG&E ELECTRIC DUCT PACKAGE	
ULO7-FO	101+28.55	RT-5.53	AT&T FIBER OPTC (2X)	
ULO8A-T	101+28.55	RT-10.25	AT&T WI TELEPHONE	
ULO8B-E	101+29.59	RT-11.32	MG&E ELECTRIC DUCT PACKAGE	
ULO9-FO	101+82.23	RT-7.73	AT&T FIBER DUCT PACKAGE	
ULO10-FO	102+44.22	RT-6.91	AT&T FIBER DUCT PACKAGE	
ULO11A-FO	104+36.65	RT-2.51	AT&T COPPER FIBER	
ULO12B-TV	104+38.61	RT-3.10	CATV	
ULO13C-E	104+40.61	RT-3.70	4" MG&E ELECTRIC	
ULO14-FO	104+58.36	RT-9.04	AT&T FIBER DUCT PACKAGE	
WATULO1-G	100+11.55	LT-4.05	2" PLASTIC MG&E GAS	

SPECIFIC NOTES

SANITARY SEWER SCHEDULE

LAKE STREET SANITARY SEWER REPLACEMENT ASSESSMENT DISTRICT - 2025 PROJECT NO. 15938	SHEET NO. U-6	U-6
SANITARY SEWER SCHEDULE		
CITY OF MADISON		

PROPOSED SANITARY STRUCTURES

SAS NO.	STATION	LOCATION (OFFSET)	TOP OF CASTING	E.I.	DEPTH (FT)	NOTES
LAKE STREET SANITARY						
SAS #20	2+49.77	CL	860.43	848.10	12.33	5' DIA; [1]; [2]
SAS #21	2+79.91	CL	860.55	848.14	12.41	6' DIA; [1]; [2]; [3]; [4]; [5]

SANITARY STRUCTURE REMOVALS & ABANDONMENTS

STRUC ID NO.	STATION	LOCATION (OFFSET)	TOP OF CASTING	E.I.	DEPTH	NOTES
LAKE STREET SANITARY						
SAS4850-089	0+62.49	RT-3.64	861.05	847.96	13.09	5' DIA.
SAS4850-008	2+50.89	RT-4.32	860.25	848.30	11.95	5'X5' RECT.
SAS4850-007	2+79.91	CL	860.56	848.22	12.34	6'X6' RECT., OFFSET STRUCTURE

SANITARY STRUCTURE ADJUSTMENTS/MODIFICATIONS

STRUC ID NO.	STATION	LOCATION (OFFSET)	TOP OF CASTING	PROP TOC	ADJ (FT)	NOTES
LAKE STREET SANITARY						
SAS4850-088	0+50.00	CL	861.09	-	-	[6]

PROPOSED SANITARY PIPES

FROM (DNSTM)	TO (UPSTM)	DWNSTRM E.I.	UPSTRM E.I.	PLAN LGTH (FT)	SLOPE (%)	PVC TYPE	NOTES
LAKE STREET SANITARY							
SAS4850-008	SAS #20	847.94	848.10	200	0.08%	24"	PS-115
SAS #20	SAS #21	848.12	848.14	30	0.08%	24"	PS-115

SANITARY PIPE REMOVALS & ABANDONMENTS

REMOVE FROM	REMOVE TO	LGTH (FT)	PAID (Y/N)	REM LGTH (FT)	REM LGTH PAID (FT)	ABN LGTH (FT)	SLURRY CY	PIPE SIZE	PIPE TYPE	NOTES
LAKE STREET SANITARY										
SAS4850-008	SAS4850-089	13	N	13	-	-	-	24"	PVC	
SAS4850-089	SAS4850-008	187	Y	-	-	187	7.40	14"	CI	
SAS4850-008	SAS4850-007	29	Y	-	-	29	0.84	12"	CI	

SANITARY ULO SCHEDULE

ID NO. (OFFSET)	STATION	LOCATION (OFFSET)	TYPE
LAKE STREET SANITARY			
SANULO21-E	1+76.96	CL	MG&E DUCT PACKAGE
SANULO22-E	2+21.00	CL	MG&E DUCT PACKAGE
SANULO23A-E	2+63.14	CL	MG&E 15-D DUCT PACKAGE
SANULO23B-G	2+67.00	CL	MG&E 4" STEEL GAS

SPECIFIC NOTES

- [1] INSTALL RIGID INTERNAL CHIMNEY SEAL IN CONFORMANCE WITH S.D.D. 5.7.17
- [2] INSTALL EXTERNAL SAS WRAP IN CONFORMANCE WITH S.D.D. 5.7.2
- [3] 12" TAP (EI(N) = 848.38) FOR UPSTREAM MAIN CONNECTION
- [4] 12" TAP (EI(W) = 850.83) FOR UPSTREAM MAIN CONNECTION, EI APPROXIMATED AS 1' ABOVE SE LAT BASED ON EXISTING STRUCTURE INSPECTION
- [5] 6" TAP (EI(SE) = 849.83) FOR EXISTING LATERAL CONNECTION
- [6] RE-USE EXISTING NORTHERN CORE FOR PROPOSED 24" SANITARY

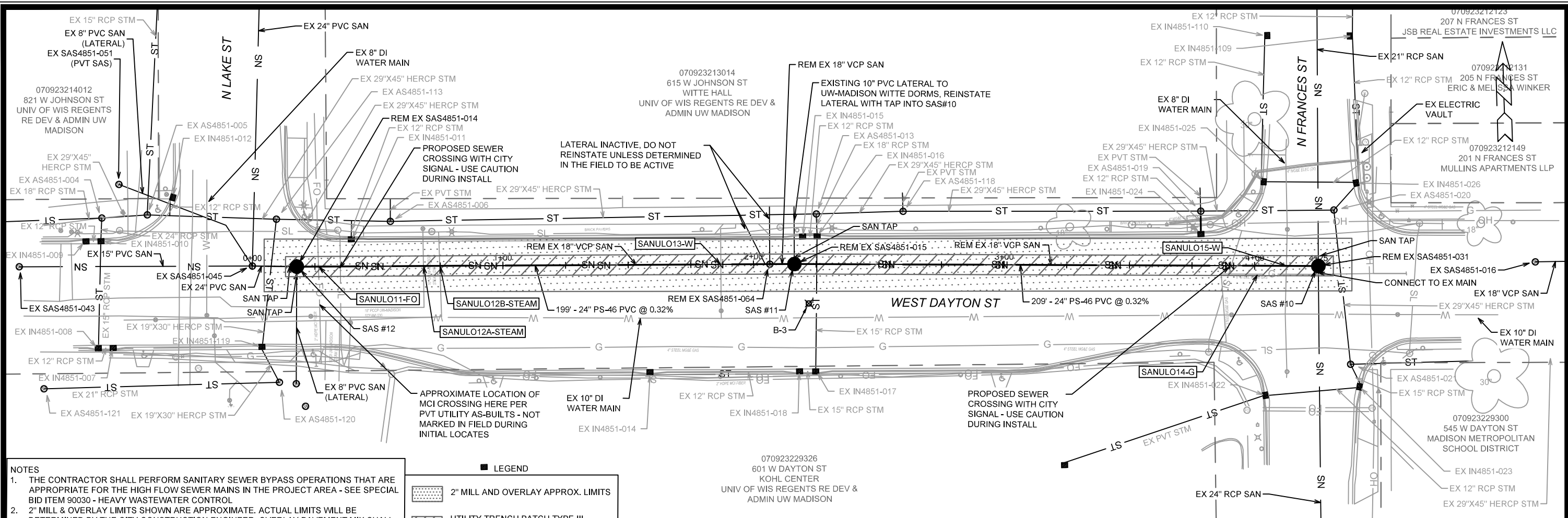

NOTES

1. THE CONTRACTOR SHALL PERFORM SANITARY SEWER BYPASS OPERATIONS THAT ARE APPROPRIATE FOR THE HIGH FLOW SEWER MAINS IN THE PROJECT AREA - SEE SPECIAL BID ITEM 90030 - HEAVY WASTEWATER CONTROL
2. 2" MILL & OVERLAY LIMITS SHOWN ARE APPROXIMATE. ACTUAL LIMITS WILL BE DETERMINED BY THE CITY CONSTRUCTION ENGINEER. OVERLAY PAVEMENT MIX SHALL BE 4 MT 58-28 S.
3. PRE-CAST SANITARY STRUCTURE SHOP DRAWINGS SHALL BE SUBMITTED TO ERIC CEFALU AT CEFALU@CITYOFMADISON.COM FOR APPROVAL PRIOR TO DELIVERY TO SITE.

LEGEND

- 2" MILL AND OVERLAY APPROX. LIMITS
- UTILITY TRENCH PATCH TYPE III APPROX. LIMITS

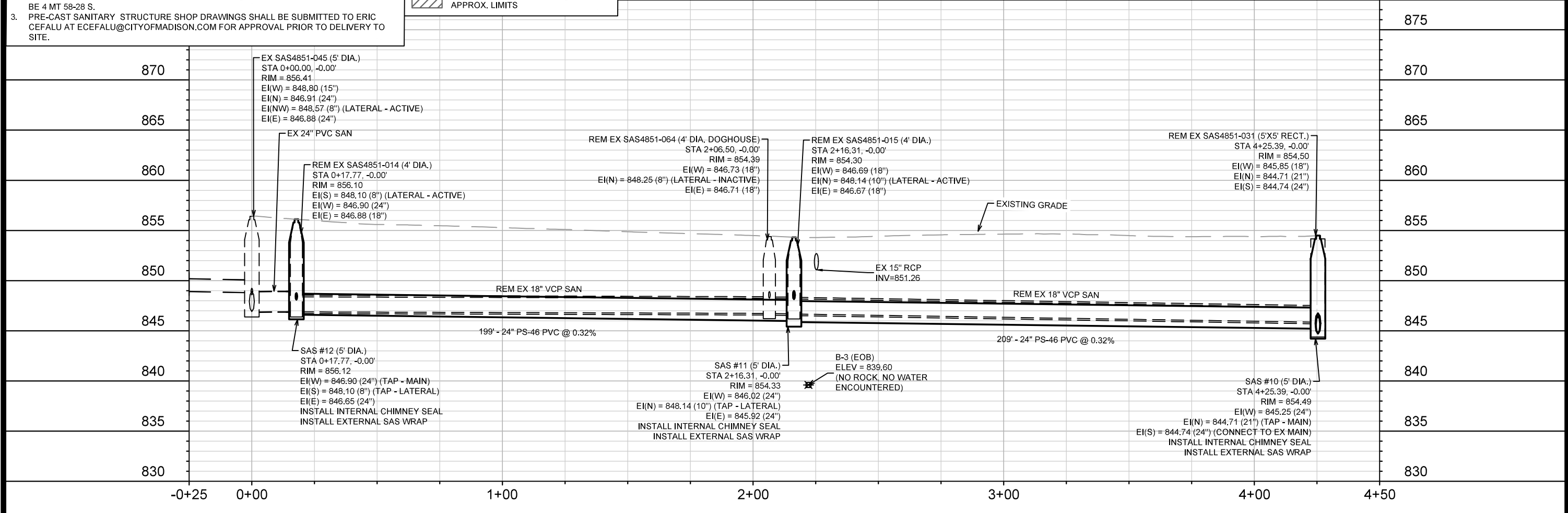

15938	15938	U-7
15938	8733	U-7
SEWER PLAN & PROFILE - W. DAYTON ST WEST DAYTON STREET SANITARY REPLACEMENT ASSESSMENT DISTRICT - 2025 MADISON, WI CONTRACT NO.: 15938 U-7		

SANITARY SEWER SCHEDULE

WEST DAYTON STREET SANITARY REPLACEMENT ASSESSMENT DISTRICT - 2025 PROJECT NO. 15938	SHEET NO. U-8
SANITARY SEWER SCHEDULE	
CITY OF MADISON	

U-8

PROPOSED SANITARY STRUCTURES

SAS NO.	STATION	LOCATION (OFFSET)	TOP OF CASTING	E.I.	DEPTH (FT)	NOTES
WEST DAYTON STREET SANITARY						
SAS #10	4+25.39	CL	854.49	844.71	9.78	5' DIA; [1]; [2]; [3]; [4]
SAS #11	2+16.31	CL	854.33	845.92	8.41	5' DIA; [1]; [2]; [5]
SAS #12	0+17.77	CL	856.12	846.65	9.47	5' DIA; [1]; [2]; [6]; [7]

PROPOSED SANITARY PIPES

FROM (DNSTM)	TO (UPSTM)	DWNSTRM E.I.	UPSTRM E.I.	PLAN LGTH (FT)	SLOPE (%)	PVC TYPE	NOTES
WEST DAYTON STREET SANITARY							
SAS #10	SAS #11	845.25	845.92	209	0.32%	24"	PS-46
SAS #11	SAS #12	846.02	846.65	199	0.32%	24"	PS-46

SANITARY STRUCTURE REMOVALS & ABANDONMENTS

STRUC ID NO.	STATION	LOCATION (OFFSET)	TOP OF CASTING	E.I.	DEPTH	NOTES
WEST DAYTON STREET SANITARY						
SAS4851-031	4+25.39	CL	854.50	844.71	9.79	5'X5' RECT.
SAS4851-015	2+16.31	CL	854.30	846.67	7.63	4' DIA.
SAS4851-064	2+06.50	CL	854.39	846.71	7.68	4' DIA. DOGHOUSE
SAS4851-014	0+17.77	CL	856.10	846.88	9.22	4' DIA.

SANITARY PIPE REMOVALS & ABANDONMENTS

REMOVE FROM	REMOVE TO	LGTH (FT)	PAID (Y/N)	REM LGTH (FT)	REM LGTH PAID (FT)	ABN LGTH (FT)	SLURRY CY	PIPE SIZE	PIPE TYPE	NOTES
WEST DAYTON STREET SANITARY										
SAS4851-031	SAS4851-015	209	N	209	-	-	-	18"	VCP	
SAS4851-015	SAS4851-064	10	N	10	-	-	-	18"	VCP	
SAS4851-064	SAS4851-014	189	N	189	-	-	-	18"	VCP	

SANITARY ULO SCHEDULE

ID NO. (OFFSET)	STATION	LOCATION (OFFSET)	TYPE
WEST DAYTON STREET SANITARY			
SANULO11-FO	0+26.45	CL	2" HDPE MCI FIBER
SANULO12A-STEAM	0+68.33	CL	10" DI UW-MADISON STEAM (CHILLED WATER)
SANULO12B-STEAM	0+74.84	CL	10" DI UW-MADISON STEAM (CHILLED WATER)
SANULO13-W	1+86.99	CL	4" DI WATER SERVICE
SANULO14-G	4+01.26	RT-3.33	6" STEEL MG&E GAS
SANULO15-W	4+12.65	CL	8" DI WATER MAIN

SPECIFIC NOTES

- [1] INSTALL RIGID INTERNAL CHIMNEY SEAL IN CONFORMANCE WITH S.D.D. 5.7.17
- [2] INSTALL EXTERNAL SAS WRAP IN CONFORMANCE WITH S.D.D. 5.7.2
- [3] CONNECT TO EX 24" RCP MAIN (EI(S) = 844.74)
- [4] 21" TAP (EI(N) = 844.71) FOR UPSTREAM MAIN CONNECTION
- [5] 10" TAP (EI(N) = 848.14) FOR EXISTING LATERAL CONNECTION
- [6] 24" TAP (EI(W) = 846.90) FOR UPSTREAM MAIN CONNECTION
- [7] 8" TAP (EI(S) = 848.10) FOR EXISTING LATERAL CONNECTION

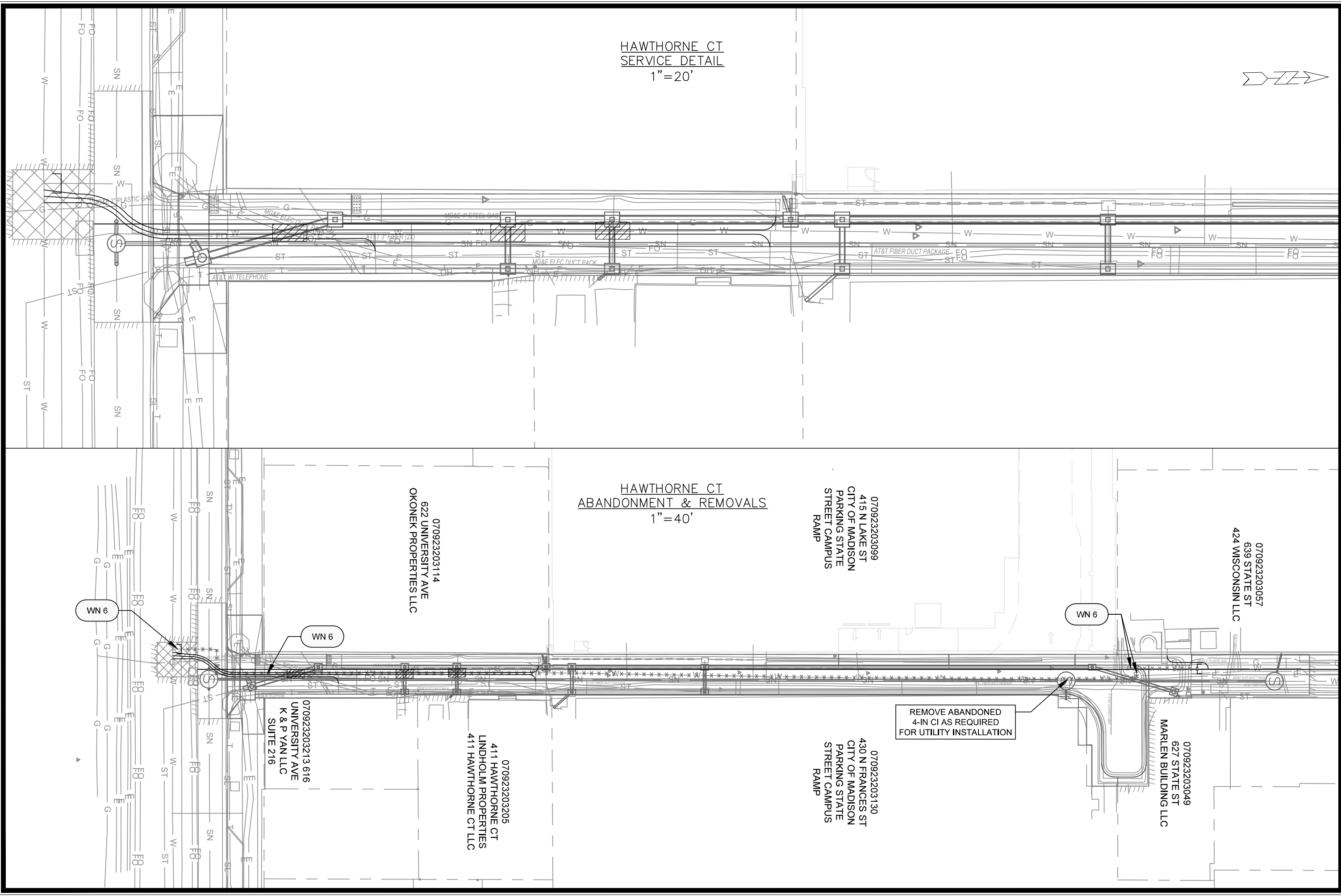

HAWTHORNE CT
SERVICE DETAIL
1"=20'

HAWTHORNE CT
ABANDONMENT & REMOVALS
1"=40'

MARK	REVISION	DATE	BY
14636	Designed By: TDP	Date: 10/03/2025	Scale: VARIES
14636			W-2

14636
 WATER DETAILS & REMOVALS - HAWTHORNE CT
 HAWTHORNE COURT RECONSTRUCTION ASSESSMENT DISTRICT - 2023
 MADISON, WI
 CONTRACT NO: 8733
 M:\DESIGN\Projects\14636\CAD\Water\14636WU\Water.dwg

 14636
 W-2



CONSTRUCTION NOTES:

1. CONSTRUCT NEW WATER MAIN 6.0' BELOW FINISHED GRADE, UNLESS OTHERWISE NOTED. INSULATE MAIN WITH POLYSTYRENE BOARD AT STORM CROSSINGS AND OTHER AREAS IDENTIFIED BY ENGINEER AS HAVING INADEQUATE COVER.
2. VERIFY SIZE OF EXISTING WATER SERVICES AND RECONNECT SERVICES AS INDICATED.
3. MINIMIZE DISRUPTION OF SERVICE TO CUSTOMERS. NOTIFY PER CONTRACT REQUIREMENTS OF ANY PLANNED WATER OUTAGE.

- WN-1 REPLACE THE EXISTING LEAD SERVICE WITH A NEW COPPER SERVICE.
- WN-2 EXTEND AND RECONNECT THE EXISTING COPPER SERVICE TO THE NEW WATER MAIN.
- WN-3 EXISTING SERVICE TO BE ABANDONED WHEN THE WATER MAIN IS CUT OFF.
- WN-4 DISCONNECT FROM THE OLD WATER MAIN AND RECONNECT THE EXISTING COPPER WATER SERVICE LATERAL TO THE NEW WATER MAIN.
- WN-5 RELOCATE THE EXISTING FIRE HYDRANT.
- WN-6 ABANDON WATER VALVE ACCESS STRUCTURE.
- WN-7 FURNISH AND INSTALL THE NEW TOP SECTION FOR THE WATER ACCESS STRUCTURE.
- WN-8 ABANDON THE VALVE BOX.
- WN-9 FURNISH THE DITCH, COMPACTION, AND ALL MATERIALS AND LABOR FOR THE INSTALLATION OF NEW SERVICE LATERAL.
- WN-10 REMOVE AND SALVAGE EXISTING HYDRANT
- WN-11 REPLACE THE EXISTING COPPER SERVICE WITH A COPPER SERVICE
- WN-20+ SEE WATER IMPACT PLAN FOR CONNECTION POINT ISOLATION AND WATER SHUT-OFF NOTIFICATION INFORMATION.

WATER UTILITY ULO SCHEDULE				
ULO	UTILITY	STATION	OFFSET	SHEET
WAT 1	GAS	100+11.6	4.1 LT	W-1

*ESTIMATE OF MATERIALS SUPPLIED BY CONTRACTOR:			
PAY_ITEM_ID	DESCRIPTION	QUANTITY	UNIT
20301	SAWCUT CONCRETE (FULL DEPTH)	60	L.F.
20321	REMOVE CONCRETE PAVEMENT	40	S.Y.
50222	UTILITY TRENCH PATCH TYPE I	40	S.Y.
50801	UTILITY LINE OPENING (ULO)	2	EACH
70056	RECONNECT 1-INCH SERVICE LATERAL, 639 STATE ST	1	EACH
70056	RECONNECT 1-INCH SERVICE LATERAL, 616 UNIVERSITY	1	EACH
70057	RECONNECT 1 1/2-INCH SERVICE LATERAL, 411 HAWTHORNE CT	1	EACH
70058	RECONNECT 2-INCH SERVICE LATERAL, 620 UNIVERSITY AVE	1	EACH
70082	CUT OFF EXISTING WATER MAIN	2	EACH
70090	ABANDON WATER VALVE BOX	2	EACH
70101	FURNISH AND INSTALL STYROFOAM	3	EACH
70104	ADJUST WATER VALVE BOX	2	EACH
70105	PIPE PLUG FOR WATER INSTALLATION	1	EACH
70110	FURNISH AND INSTALL TEMP WATER SYSTEM	1	LUMP SUM
70111	FURNISH & INSTALL ANODE	1	EACH
*ESTIMATE OF MATERIALS SUPPLIED BY WATER UTILITY:			
N/A			
*ESTIMATE OF MATERIALS SALVAGED:			
N/A			

* ESTIMATE OF MATERIALS IS FOR INFORMATION ONLY. ENGINEER DOES NOT GUARANTEE ACCURACY OF MATERIAL TAKE-OFF.

TO OBTAIN LOCATION OF PARTICIPANTS' UNDERGROUND FACILITIES BEFORE YOU DIG IN WISCONSIN

CALL DIGGERS HOTLINE TOLL FREE
811 OR 1-800-242-8511
FAX-A-LOCATE 1-800-338-3860
TDD (FOR HEARING IMPAIRED) 1-800-542-2289

WIS. STATUTE 182.0175 (1974) REQUIRES MIN. OF 3 WORK DAYS NOTICE BEFORE YOU EXCAVATE.

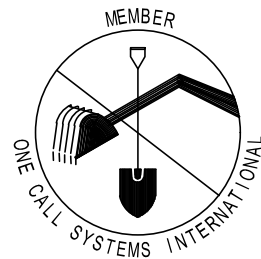

DISCLAIMER NOTE: UTILITY LOCATIONS SHOWN ARE APPROXIMATE ONLY. IT SHALL BE THE CONTRACTOR'S RESPONSIBILITY TO DETERMINE THE EXACT HORIZONTAL AND VERTICAL LOCATION OF ALL EXISTING UNDERGROUND AND OVERHEAD UTILITIES PRIOR TO COMMENCING WORK.

PART VII - WATER MAINS AND SERVICE LATERALS **DETAIL DRAWING NO. 7.04**

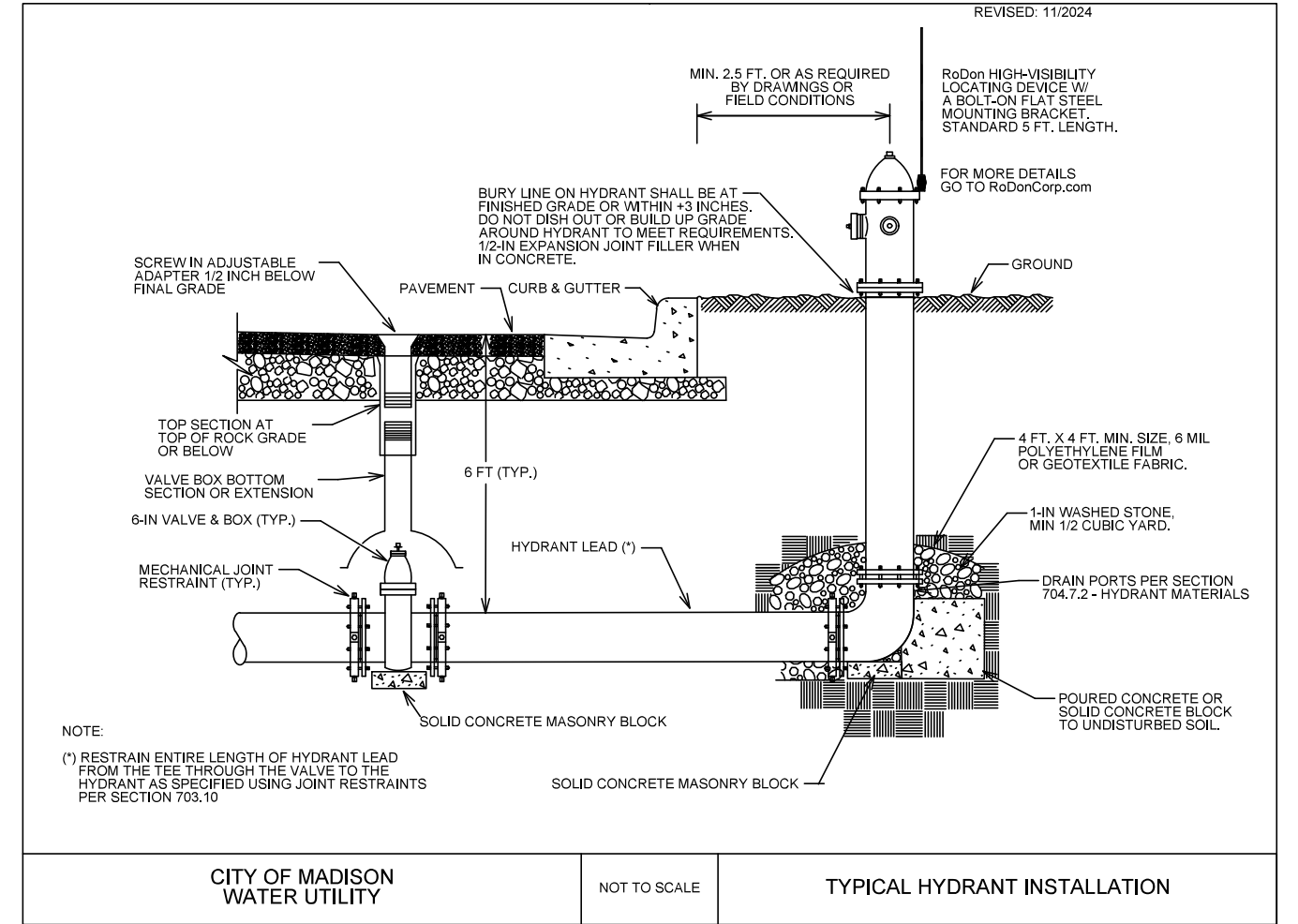

CITY OF MADISON WATER UTILITY

NOT TO SCALE

TYPICAL HYDRANT INSTALLATION

City of Madison Standard Specifications for Public Works Construction

MARK	REVISION	DATE	BY
14636	14636	12/17/2025	12:19 PM

14636
MADISON, WI
CONTRACT NO: 8733
W-4

ESTIMATE OF WATER MATERIALS - HAWTHORNE CT
HAWTHORNE COURT RECONSTRUCTION ASSESSMENT DISTRICT - 2023
M:\DESIGN\Projects\14636\CAD\Water\14636WU-Materials.DWG



14636
W-4

UNIVERSITY AVE

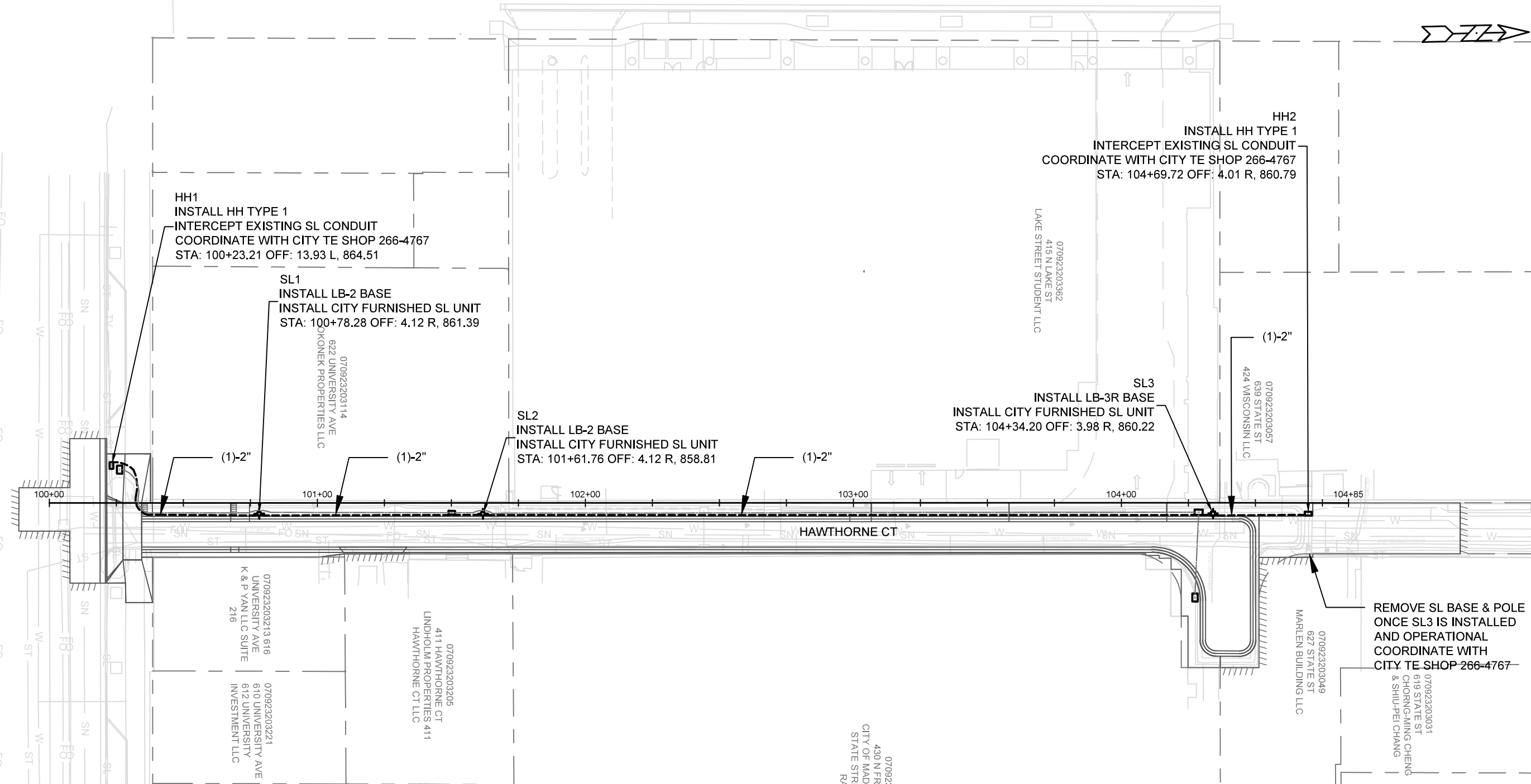

GENERAL ELECTRICAL NOTES

- ALL LOCATIONS ARE APPROXIMATE, THE TRAFFIC ENGINEER SHALL APPROVE FINAL LOCATIONS, INCLUDING SETBACK IN THE FIELD, AFTER CONTRACTOR SURVEYS STAKING. THE CONTRACTOR SHALL NOTIFY JERRY SCHIPPA (JSCHIPPA@CITYOFMADISON.COM), AT LEAST 24HOURS IN ADVANCE OF NEEDING BASE LOCATIONS MARKED.
- BASES INSTALLED IN TERRACE SHALL BE 4' FROM FACE OF CURB UNLESS OTHERWISE NOTED, SUBJECT TO NOTE 1 ABOVE.
- CONCRETE BASES AND HANDHOLES TO BE INSTALLED BY THE CONTRACTOR ARE PROVIDED WITH STATION, OFFSET & ELEVATION OF FINAL SURFACE AT THE CENTER OF THE STRUCTURE. BASE INSTALLATION SHALL FOLLOW STANDARD DETAIL DRAWING 6.01.
- THE CONTRACTOR SHALL DO ALL WORK IN ACCORDANCE WITH "CITY OF MADISON STANDARD SPECIFICATIONS FOR PUBLIC WORKS CONSTRUCTION, LATEST EDITION" AND ADDEMDUMS THERETO. cityofmadison.com/engineering/documents/standard-specifications/CompleteSpecBook.pdf
- THE CONTRACTOR SHALL CALL CITY TE SHOP (266-4767) AT THE TRAFFIC ENGINEERING SHOP AT LEAST 24-HOURS IN ADVANCE OF POURING BASES OR BURYING CONDUIT TO ARRANGE FOR INSPECTION. ANY WORK COMPLETED WITHOUT INSPECTION IS SUBJECT TO REJECTION.
- THE CONTRACTOR SHALL CALL CITY TE SHOP (266-4767) PRIOR TO REMOVING OR CONNECTING TO EXISTING CONDUITS OR HANDHOLES. CONTRACTOR SHALL FIELD VERIFY CONDUIT SIZE.
- THE CONTRACTOR SHALL INSTALL 3#6 & 1#8 WIRES IN ALL NEW CONTRACTOR INSTALLED 2" CONDUIT.
- THE CONTRACTOR SHALL INSTALL TRACER WIRE IN ALL NEW CONTRACTOR INSTALLED 3" CONDUIT.
- THE CONTRACTOR SHALL ARRANGE FOR PICKUP OF THE FOLLOWING CITY MATERIALS:
 - 3/4" X 24" ANCHOR BOLTS: 2 SETS OF 4 FOR LB-2 BASES
 - 1" X 40" ANCHOR BOLTS: 1 SET OF 4 FOR LB-3R BASES

MARK	REVISION	DATE	BY

Designed By: GMA Date: 12/12/2023 10:33 AM
Scale: 1"=40'
14636

14636
ELECTRICAL PLAN (LIGHTING) - HAWTHORNE CT
HAWTHORNE COURT RECONSTRUCTION ASSESSMENT DISTRICT - 2023 MADISON, WI
CONTRACT NO: 8733
M:\DESIGN\Projects\14636\CAD\Traffic\14636TE-Electrical.dwg

14636
E-1

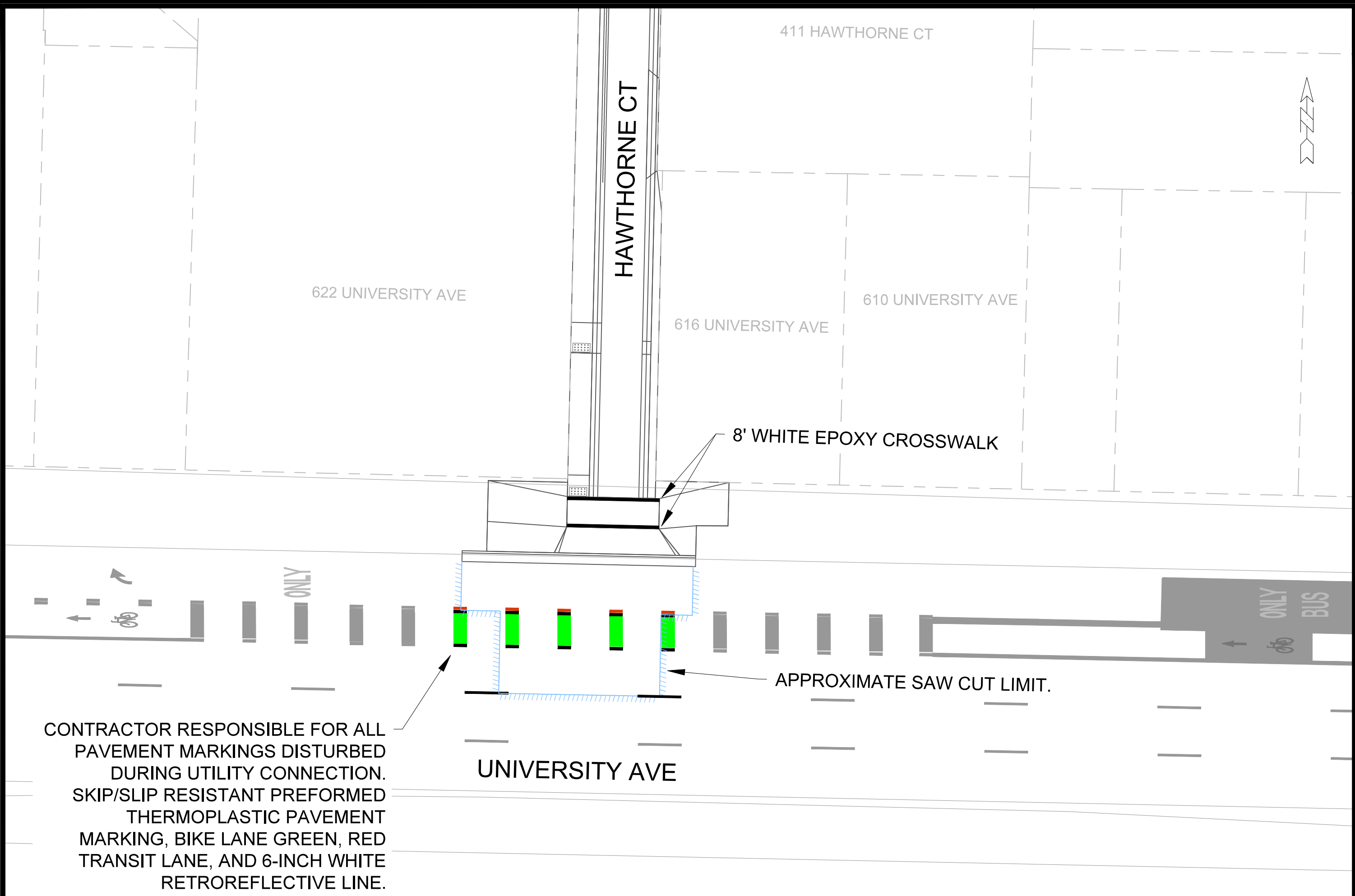

411 HAWTHORNE CT

622 UNIVERSITY AVE

HAWTHORNE CT

616 UNIVERSITY AVE

610 UNIVERSITY AVE

8' WHITE EPOXY CROSSWALK

APPROXIMATE SAW CUT LIMIT.

UNIVERSITY AVE

CONTRACTOR RESPONSIBLE FOR ALL PAVEMENT MARKINGS DISTURBED DURING UTILITY CONNECTION. SKIP/SLIP RESISTANT PREFORMED THERMOPLASTIC PAVEMENT MARKING, BIKE LANE GREEN, RED TRANSIT LANE, AND 6-INCH WHITE RETROREFLECTIVE LINE.

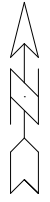

MARK	REVISION	DATE	BY

14636
 PAVEMENT MARKING PLAN - HAWTHORNE CT
 HAWTHORNE COURT RECONSTRUCTION ASSESSMENT DISTRICT - 2023
 MADISON, WI
 CONTRACT NO: 8733
 M:\DESIGN\Projects\14636\CAD\Traffic\14636TE-PavementMarking.dwg



14636
 PM-1

W. JOHNSON ST

UNIVERSITY AVE

N. LAKE ST

REMOVE ALL PAVEMENT MARKINGS ON N. LAKE ST BETWEEN UNIVERSITY AVE AND W. JOHNSON ST. EXISTING CROSSWALKS TO REMAIN.



15938
PM-2

N. LAKE ST - PAVEMENT MARKING REMOVALS
WEST DAYTON STREET RESURFACING & NORTH LAKE STREET RESURFACING
M:\DESIGN\Projects\14636\CAD\Traffic\14636TE-PavementMarking Removal.dwg

15938
MADISON, WI
CONTRACT NO: 8733

MARK	ADD.1	REVISION	ADD.1	DATE	12/15/25	LG	BY
15938	15938	15938	15938	15938	15938	15938	15938
Designed By: ##				Date: 12/15/2025 11:08 AM		Scale: 1:30	
15938				15938		PM-2	

W. JOHNSON ST

UNIVERSITY AVE

Callout	Description
1	PAVEMENT MARKING EPOXY, CROSSWALK, 12-INCH
2	PAVEMENT MARKING EPOXY, STOP LINE, 24-INCH
3	PAVEMENT MARKING EPOXY, LINE, 8-INCH
4	PAVEMENT MARKING EPOXY, LINE, 6-INCH
5	PAVEMENT MARKING EPOXY, DOUBLE LINE, 4-INCH YELLOW
6	PAVEMENT MARKING EPOXY, SYMBOL, BIKE LANE
7	PAVEMENT MARKING EPOXY, SYMBOL, STRAIGHT ARROW
8	PAVEMENT MARKING EPOXY, WORD, ONLY
9	PAVEMENT MARKING EPOXY, SYMBOL, RIGHT ARROW
10	PAVEMENT MARKING EPOXY, SYMBOL, BIKE LANE & STRAIGHT ARROW
11	PAVEMENT MARKING EPOXY, SYMBOL, BIKE SHARROW
12	PAVEMENT MARKING EPOXY, DASHED LINE, 6-INCH (2' LINE WITH 6' GAP)
13	PAVEMENT MARKING EPOXY, DASHED LINE, 6-INCH YELLOW (10' LINE WITH 30' GAP)
14	PAVEMENT MARKING EPOXY, CROSSWALK, 6-INCH
15	PAVEMENT MARKING EPOXY, CONTINENTAL CROSSWALK, 18-INCH
16	PAVEMENT MARKING EPOXY, DASHED LINE, 6-INCH WHITE (10' LINE WITH 30' GAP)

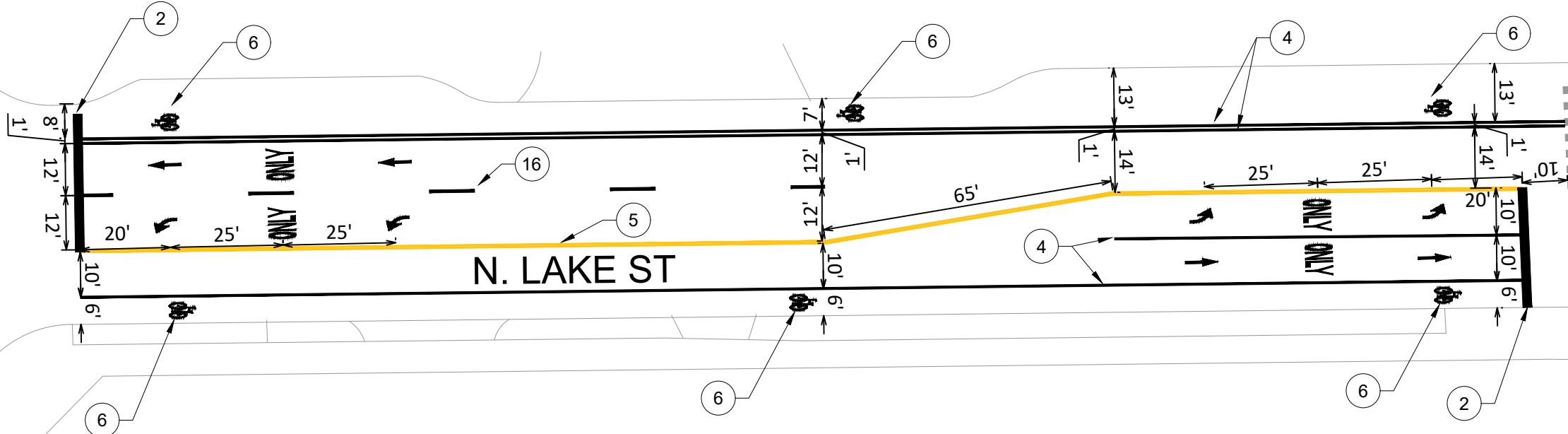

N. LAKE ST

MARK	REVISION	DATE	BY
ADD.1	ADDENDUM 1	12/15/25	LG

15938
 15938
 MADISON, WI
 8733
 CONTRACT NO:
 WEST DAYTON STREET RESURFACING & NORTH LAKE STREET RESURFACING
 M:\DESIGN\Projects\14636\CAD\Traffic\14636TE-PavementMarking.dwg



15938
 PM-3

Scale: 1:30
 15938
 12/15/25 10:53 AM
 PM-3

UNIVERSITY AVE

ONLY BUS

ONLY

622 UNIVERSITY AVE

LAKE STREET STUDENT LLC
070923203362
415 N LAKE ST

070923203057
639 STATE ST
424 WISCONSIN LLC

Callout	Description
1	PAVEMENT MARKING EPOXY, CROSSWALK, 12-INCH
2	PAVEMENT MARKING EPOXY, STOP LINE, 24-INCH
3	PAVEMENT MARKING EPOXY, LINE, 8-INCH
4	PAVEMENT MARKING EPOXY, LINE, 6-INCH
5	PAVEMENT MARKING EPOXY, DOUBLE LINE, 4-INCH YELLOW
6	PAVEMENT MARKING EPOXY, SYMBOL, BIKE LANE
7	PAVEMENT MARKING EPOXY, SYMBOL, STRAIGHT ARROW
8	PAVEMENT MARKING EPOXY, WORD, ONLY
9	PAVEMENT MARKING EPOXY, SYMBOL, RIGHT ARROW
10	PAVEMENT MARKING EPOXY, SYMBOL, BIKE LANE & STRAIGHT ARROW
11	PAVEMENT MARKING EPOXY, SYMBOL, BIKE SHARROW
12	PAVEMENT MARKING EPOXY, DASHED LINE, 6-INCH (2' LINE WITH 6' GAP)
13	PAVEMENT MARKING EPOXY, DASHED LINE, 6-INCH YELLOW (10' LINE WITH 30' GAP)
14	PAVEMENT MARKING EPOXY, CROSSWALK, 6-INCH
15	PAVEMENT MARKING EPOXY, CONTINENTAL CROSSWALK, 18-INCH

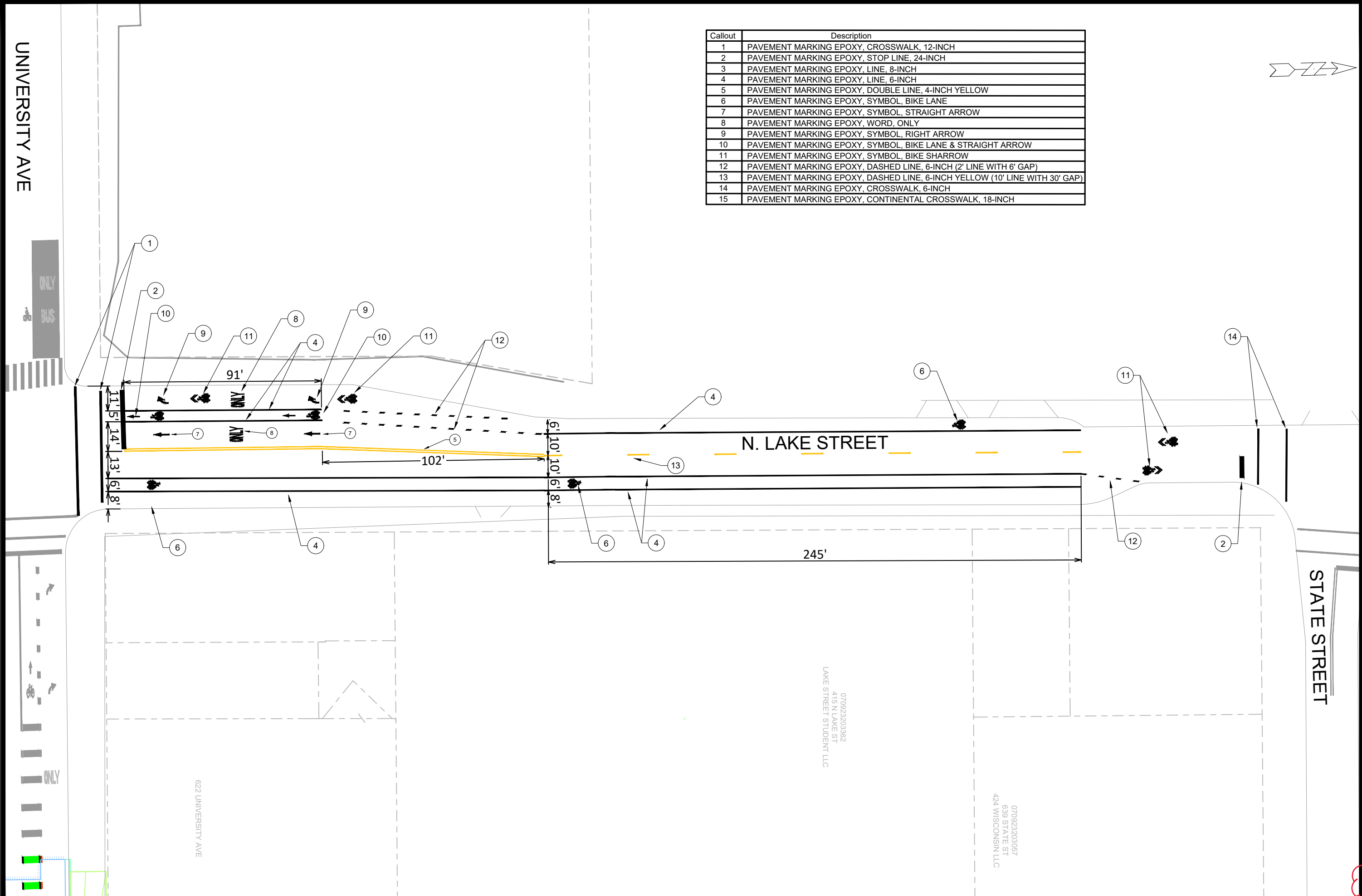
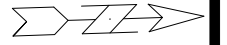

ADD. 1	REVISION	DATE	BY
ADD. 1	ADDENDUM 1	12/15/25	LC

15938
 WEST DAYTON STREET RESURFACING & NORTH LAKE STREET RESURFACING
 MADISON, WI
 CONTRACT NO: 8733



15938
 PM-4

M:\DESIGN\Projects\14636\CAD\Traffic\14636TE-PavementMarking.dwg

Designed By: ## 15938 Date: 12/15/2025 10:53 AM Scale: 1" = 40' PM-4

N. LAKE STREET

N. FRANCES ST

E. DAYTON ST

18-INCH CONTINENTAL CROSSWALK EPOXY

4-INCH DOUBLE YELLOW EPOXY

6-INCH EPOXY LINE

APPROXIMATE SAW CUT LIMITS.
CONTRACTOR RESPONSIBLE FOR ALL
DISTURBED MARKINGS DUE TO SANITARY
REPLACEMENT WORK

EPOXY BIKE SYMBOL

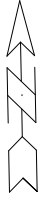

PAVEMENT MARKING PLAN - E. DAYTON ST

15938

WEST DAYTON STREET RESURFACING & NORTH LAKE STREET RESURFACING

MADISON, WI

M:\DESIGN\Projects\14636\CAD\Traffic\14636TE-PavementMarking.dwg

CONTRACT NO: 8733

MARK	ADD. 1	REVISION	ADDENDUM 1	DATE	12/15/25	LC	BY
Designed By: ##	15938	Date: 12/15/2025 10:54 AM	Scale: 1" = 40'				PM-5



15938

PM-5

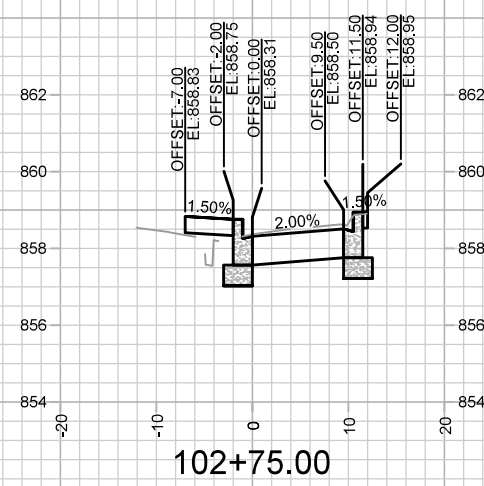
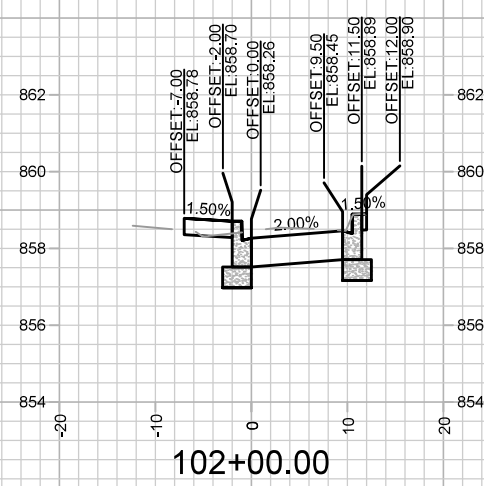
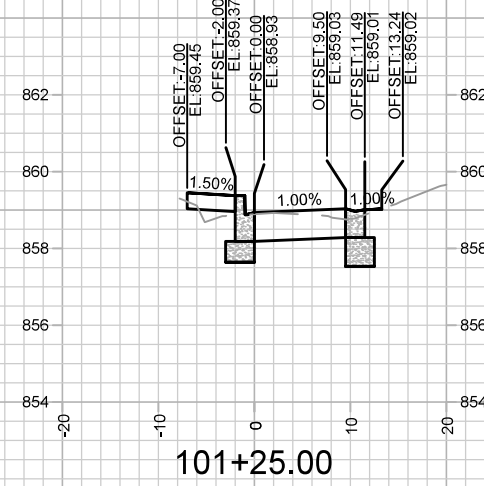
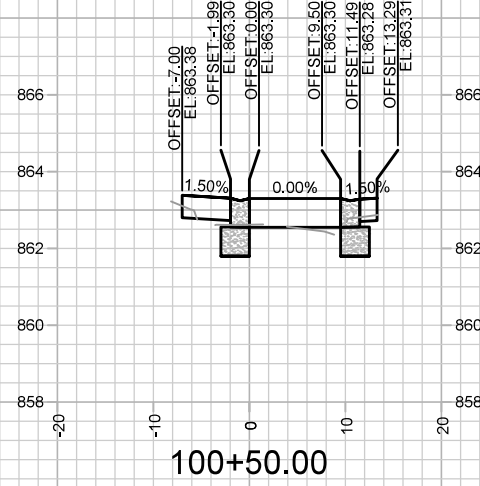
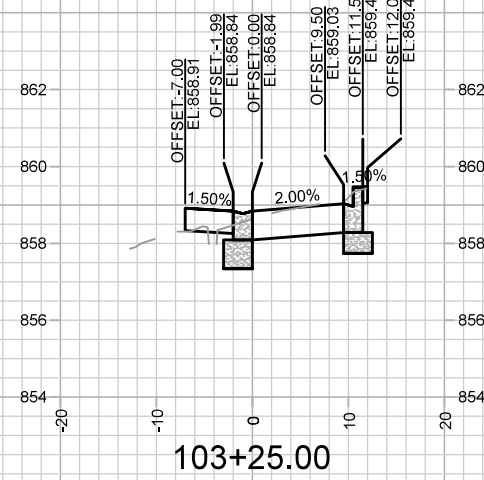
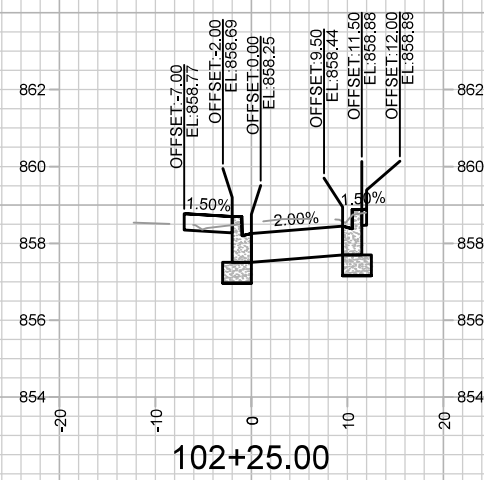
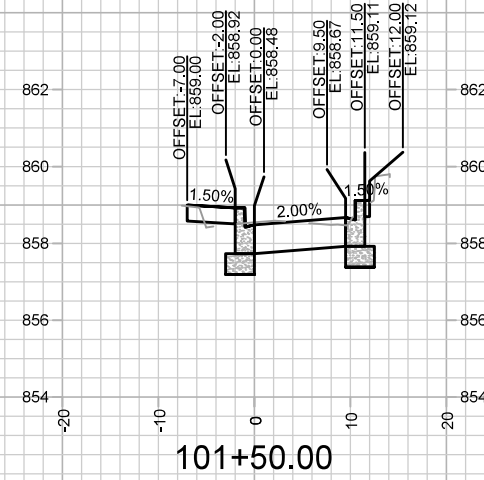
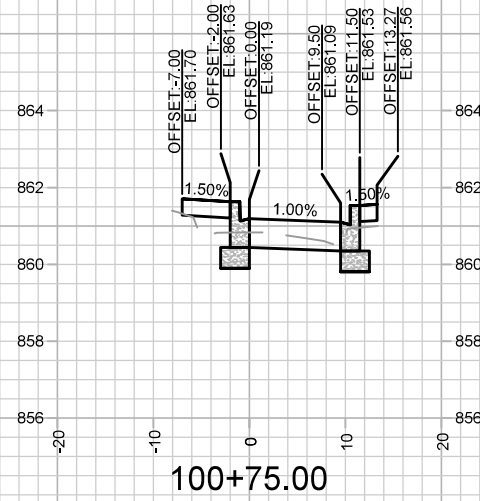
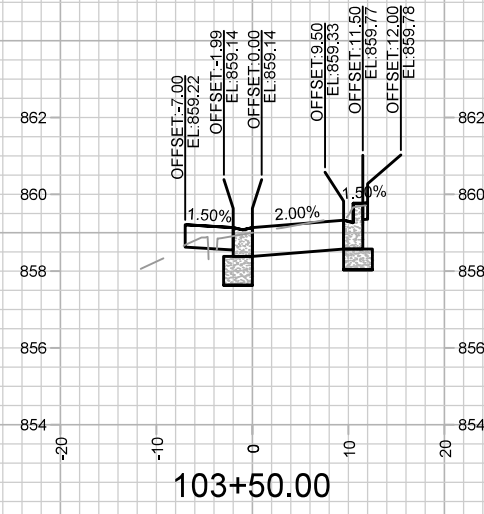
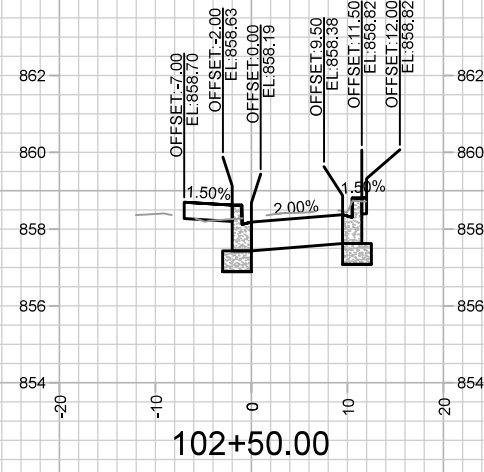
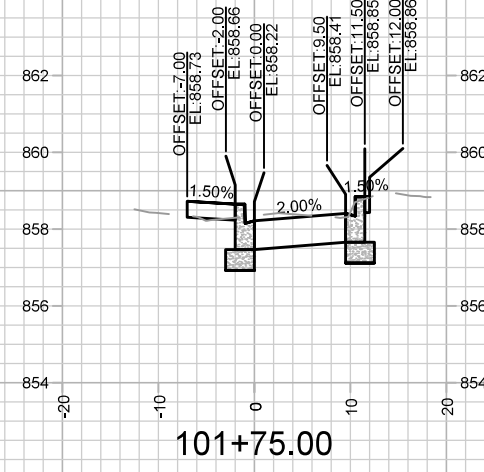
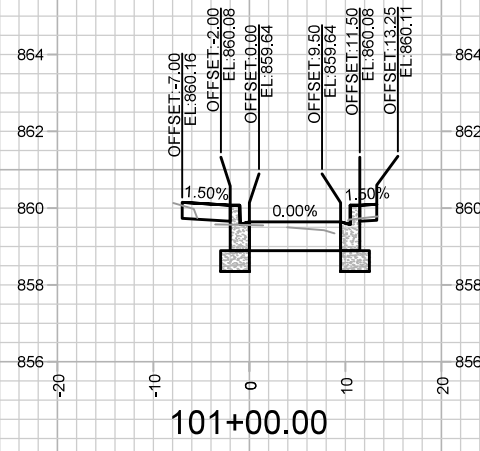

MARK	REVISION	DATE	BY

14636
 8733
 CONTRACT NO:

CROSS SECTIONS - HAWTHORNE CT
 HAWTHORNE COURT RECONSTRUCTION ASSESSMENT DISTRICT - 2023 MADISON, WI
 M:\DESIGN\Projects\14636\CAD\Streets\14636EN-X\Sheets.dwg



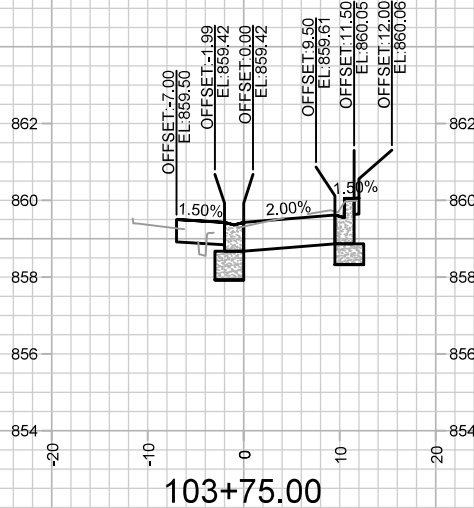
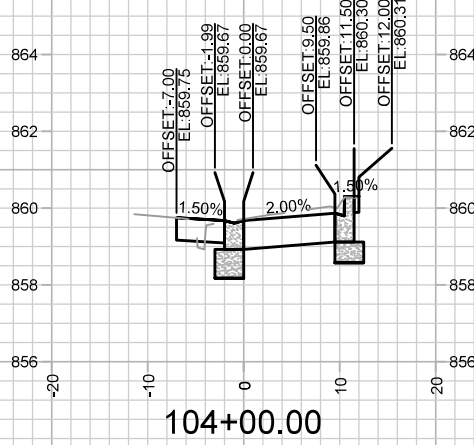
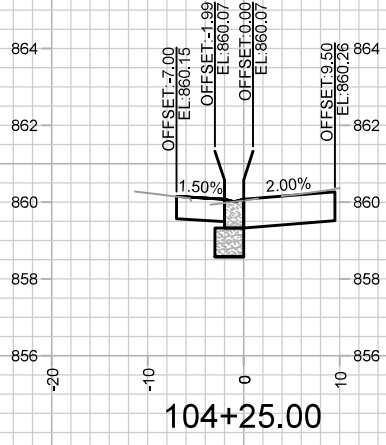

MARK	REVISION	DATE	BY
14636	8/28/2023 9:42 AM		
Designed By: EEA			Scale: 1" = 20'
14636			X-2

14636
 CROSS SECTIONS - HAWTHORNE CT
 HAWTHORNE COURT RECONSTRUCTION ASSESSMENT DISTRICT - 2023 MADISON, WI
 M:\DESIGN\Projects\14636\CAD\Streets\14636EN-X\Sheets.dwg
 CONTRACT NO: 8733



14636
 X-2

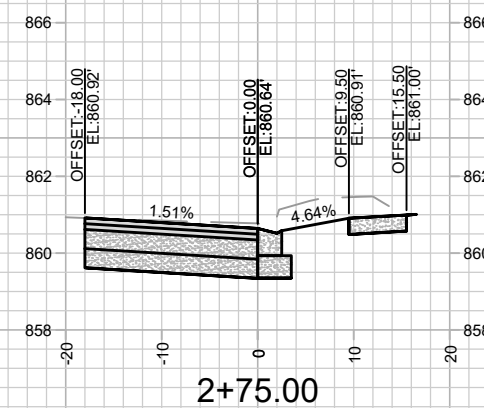
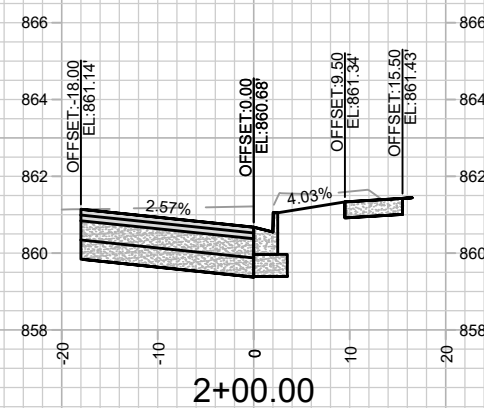
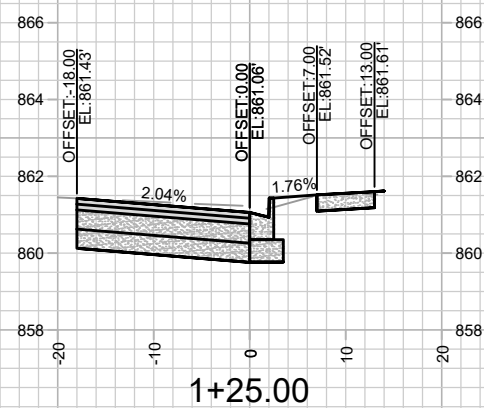
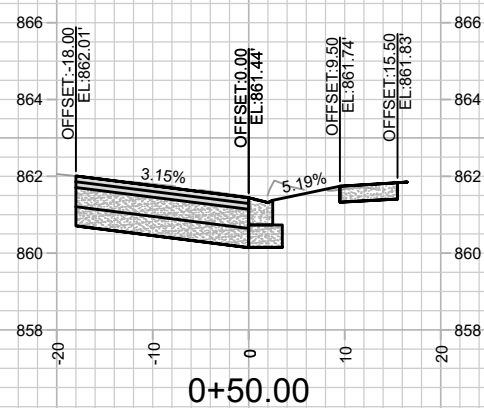
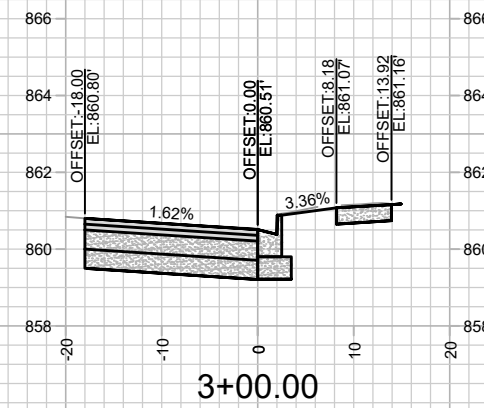
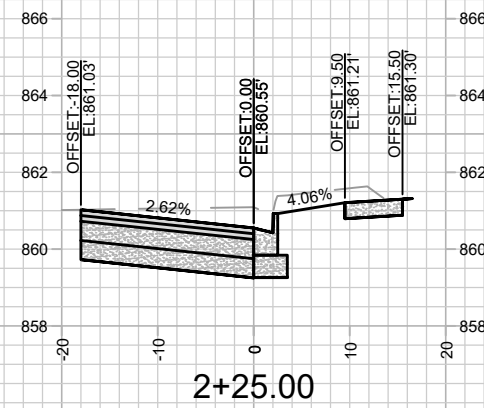
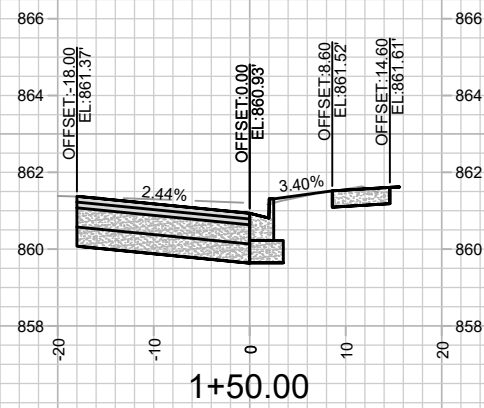
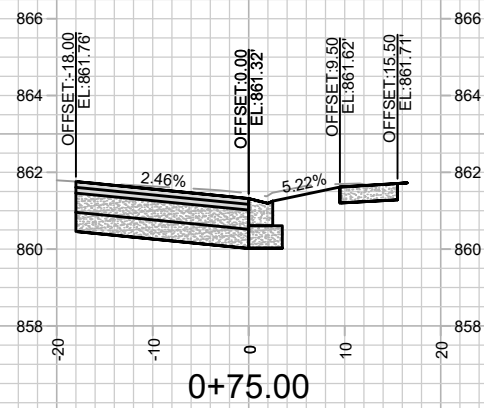
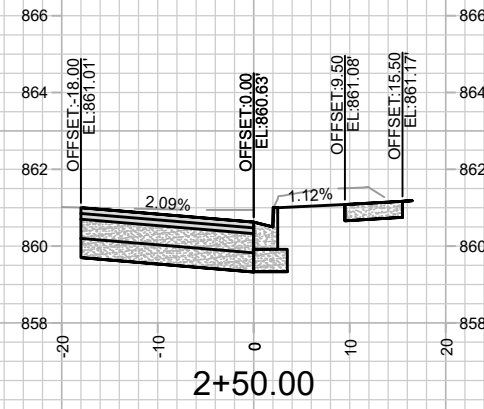
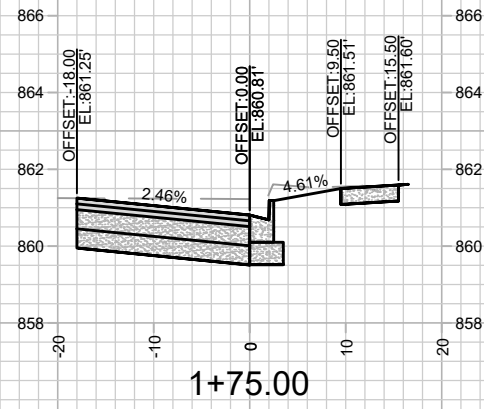
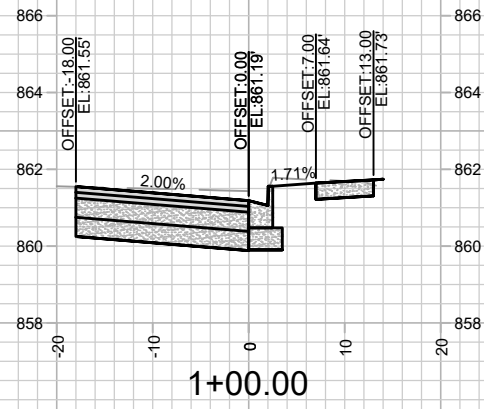

NOTES
 - SEE SHEET D-1 FOR DETAILS
 - CURB & GUTTER, TERRACE, AND SIDEWALK WORK ON N. LAKE ST TO BE COMPLETED BY OTHERS AND IS SHOWN FOR INFORMATION ONLY.

ADD. 1	ADDENDUM 1	DATE	BY
MARK	REVISION	12/15/25	RES
Designed By: GCIT	Date: 12/12/2025 11:25 AM	Scale: 1" = 20'	X-3
15938			

15938
 WEST DAYTON STREET RESURFACING & NORTH LAKE STREET RESURFACING
 MADISON, WI
 CONTRACT NO.: 8733



15938
 X-3